

ROSTFREI
Inox
Stainless
Steel

Pin Ø 10 / 12
Ball retainer both-sided

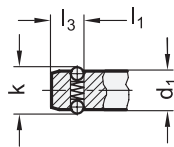

Application example

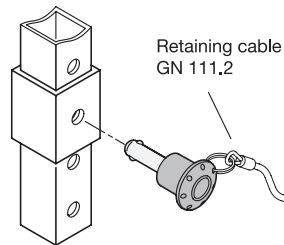

1 2

$d_{1-0,04}$ $-0,08$	l_1						d_2	d_3	k	l_2	l_3	Locating bore	Axial holding force in N \approx
6	10	15	20	25	30	50	26	17,5	6,5	22	5	6	8
8	15	20	25	30	50	-	26	17,5	8,7	22	6,3	8	15
10	15	20	25	30	50	-	34	23	12	28,5	8,7	10	30
12	20	30	40	50	-	-	34	23	14,5	28,5	9,5	12	32

Specification

- Pin
Stainless steel AISI 303
- Knob
Plastic
Technopolymer (Polyamide PA)
- Black-gray
- Temperature resistant up to 80 °C
- Ball
Stainless steel AISI 420C
- Pressure spring
Stainless steel AISI 631
- *Load Capacity* → Page 2131
- *Plastic Characteristics* → Page 2158
- *Stainless Steel Characteristics* → Page 2166
- RoHS

Information

Stainless steel locking pins GN 124.2 are used for quick fixing, connecting and locking of various jig and fixture systems.

The locking balls are held in position by a pressure spring and are therefore not rigidly locked. The bolts can be quickly and easily inserted and removed from the locating hole.

The technical appendix contains the load capacities for the double-sided shearing resistance (breaking strength).

see also...

- *List of Lock Pin Types* → Page 1008 ff.
- *Stainless Steel Locking Pins GN 214.3* → Page 1023
- *Stainless Steel Locking Pins GN 114.3* → Page 1020
- *Guide Bushings DIN 172 (Cylindrical, with Collar)* → Page 1112
- *Guide Bushings DIN 179 (Cylindrical, without Collar)* → Page 1112

Accessory

- Ball Chains GN 111 / GN 111.5 → Page 1174
- Retaining Cables GN 111.2 → Page 1176
- Spiral Retaining Cables GN 111.4 → Page 1175

How to order

GN 124.2-10-20

1 d_1
2 l_1