

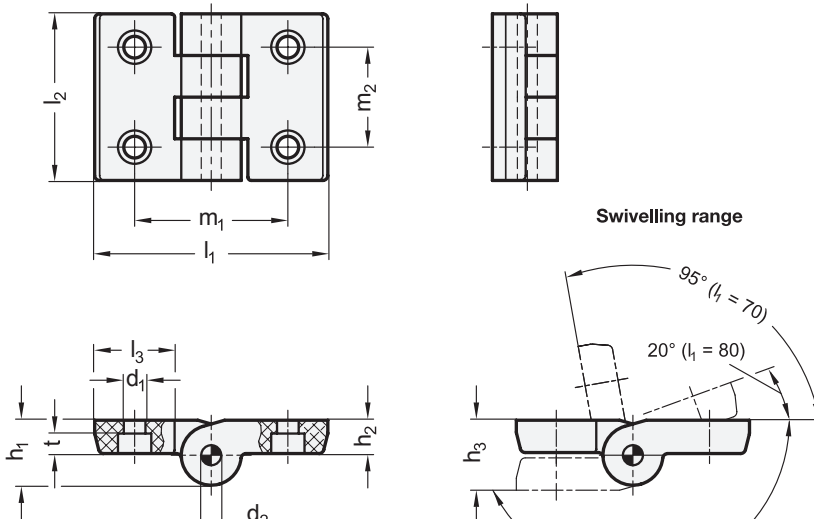

ELESA original design CFH. / CFL.



Swivelling range

1	2	3	$l_1$ -0,5	$l_2$	$d_1$	$d_2$	$h_1$	$h_2$	$h_3$	$l_3$	$m_1 \pm 0,25$	$m_2 \pm 0,25$	$t$	for screws DIN 7984
			70	50	6,5	6	19,5	10	21	24	45,5	30	6,5	M 6
			70	50	8,5	6	19,5	10	21	24	45,5	30	4,5	M 8
			80	102	6,5	5	20,5	13	26	35,5	49,5	72,5	6,5	M 6
			80	102	8,5	5	20,5	13	26	35,5	49,5	72,5	8	M 8

### Specification

- Plastic (Polyamide PA)
  - black, matte
  - temperature resistant up to 80 °C
- Pin  
Stainless Steel AISI 303
- *Plastic characteristics* → Page 1483
- *Stainless Steel characteristics* → Page 1489
- *Load rating information* → Page XYZ
- **RoHS compliant**

How to order

**GN 157-70-50-8,5**

1	$l_1$
2	$l_2$
3	$d_1$

3.1  
3.2  
3.3  
3.4  
3.5  
3.6  
3.7  
3.8  
3.9

