

EDDELSTAHL® Rostfrei
Inox
Stainless Steel

- 3 Type**
- A** Stud, unthreaded (for welding on)
 - B** Stud, with female thread
 - C** Stud, with male thread
 - DH** Fastening flange, horizontal
 - E** Plate (for welding on)

Assembly instruction and accessory

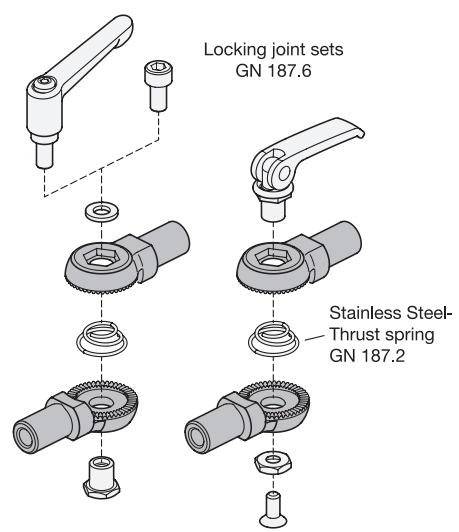
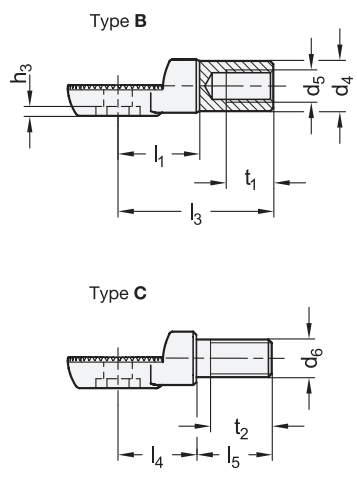

1 **2**

d ₁	z Number of teeth	b	d ₂	d ₃	d ₄	d ₅	d ₆	d ₇	d ₈	h ₁ Middle of the teeth	h ₂ (2 x h ₁)	h ₃	h ₄	h ₅	
27	48	60	46	9	18	13	M 8	M 10	5,3	2,5	8	16	3	20	1,5
32	48	60	54	9	21	16	M 10	M 12	6,5	3	9,5	19	3	22	2
40	48	60	70	11	27	20	M 12	M 16	8,5	4	12	24	4	30	2,5

d ₁	k	l ₁	l ₂	l ₃	l ₄	l ₅	l ₆	m ₁	m ₂	s ₁	s ₂	t ₁	t ₂	w min. Stroke
27	5	21	20	40,5	21	20	21	32	17	14	12	12	17	0,8
32	6	26	24	49,5	25	24	25	38	20	17	12	15	20	0,8
40	7	31,5	32	63	31	32	30,5	48	24	22	14	18	26	1

Application examples

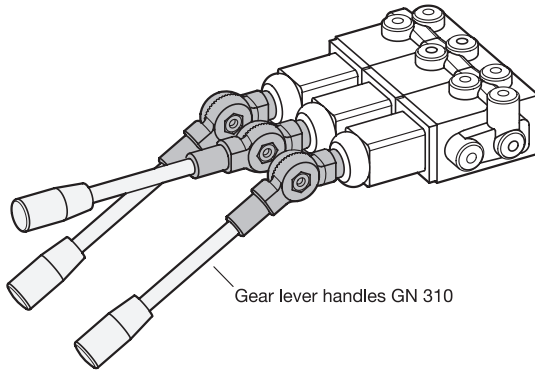

Control device

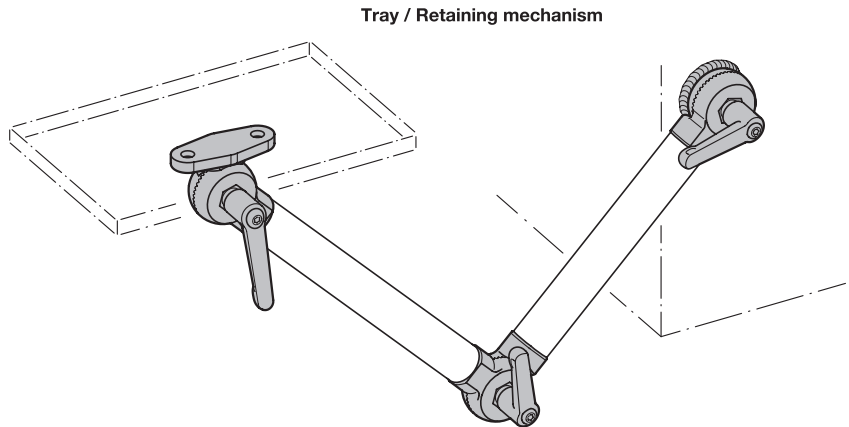

Tray / Retaining mechanism

Specification

- Stainless Steel precision casting **NI**
- AISI CF-8 matte shot-blasted
- *Stainless Steel characteristics* → Page 1479
- **RoHS**

Accessory

- Locking joint sets GN 187.6
→ *New products*
- Serrated locking plates GN 187.4 (Steel / Stainless Steel) → Page 824
- Stainless Steel-Thrust springs GN 187.2
→ Page 824

Information

Stainless Steel-Locking plates GN 187.5 can be installed in combination with locking joint sets GN 187.6 to create locking joints. This allows gear lever handles and retaining tubes or trays and mounts to be adjusted relative to each other at defined angles with a form-locking connection. The angle orientation of the teeth is adapted to the connecting elements, permitting an axis-parallel or right-angled arrangement.

Held together and centered by locking joint sets, the various types can be combined together arbitrarily with identical the nominal sizes d_1 . Stainless Steel-Thrust springs GN 187.2 can be placed between the locking heads during mounting, allowing a clean separation upon removal. Additional design possibilities arise from the compatibility of the locking heads with the locking plates GN 187.4.

When welding on, type E be easily positioned on the opposing part and fastened by means of the mounting holes d_8 (which are aligned with the teeth) using dowel pins or positioning pins.

see also...

- *Stainless Steel-Serrated locking plates GN 188* → *New products*

How to order

1	d_1
2	Number of teeth z
3	Type
4	Material

GN 187.5-32-48-DH-NI