

Type A
without seals

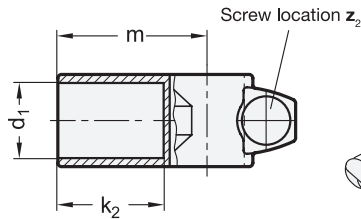

Type B
with seals

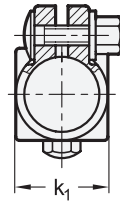
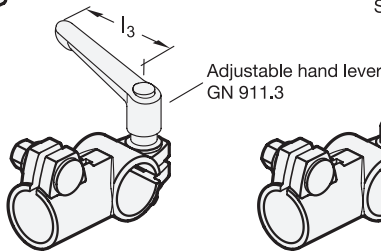
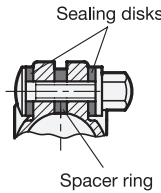

Adjustable hand lever
GN 911.3



3 Type

- A Without seals
- B With seals

4 Identification no.

- 4 With 2 stainless steel cap nuts DIN 917

1 2

d ₁ Bore	d ₂ Bore	b	k ₁ Clamping length	k ₂ Clamping length	l ₁	l ₂	m	z ₁ Screw location	z ₂ Screw location	Accessory Recom. hand lever GN 911.3			
										for z ₁ l ₃		for z ₂ l ₃	
B 30	B 30	22	37	42	96	35	60	M 8	M 8	63	78	63	78
B 50	B 50	30	65	75	151,5	48,5	103	M 10	M 10	78	92	78	92

Specification

- Stainless steel AISI CF-8
Matte shot-blasted
- Carriage bolt DIN 603
Stainless steel
- Cap nuts DIN 917 / Washers
Stainless steel
- Seals
 - Sealing disks
Plastic (Polyacetal POM)
 - Spacer ring
Silicon, 40 ... 60 Shore A
- *Plastic Characteristics* → Page 2158
- *Stainless Steel Characteristics* → Page 2166
- RoHS

Accessory

- Adjustable Hand Levers GN 911.3
→ Page 1785

Information

The clamping bores of T-angle connector clamps 192.5 are mechanically machined and designed for construction tubes GN 990 or DIN 2391, DIN 2395 and DIN 2462.

At the screw locations z₁ / z₂ carriage bolts and cap nuts reduce the bore cross-section for clamping. Type B is equipped with seals at the screw locations.

For clamping without tools, the cap nuts can be replaced by adjustable hand levers GN 911.3 listed in the table as accessories.

see also...

- *Stainless Steel Construction Tubes GN 990* → Page 1835

How to order

1	d ₁
2	d ₂
3	Type
4	Identification no.

GN 192.5-B30-B30-A-4

3.1
3.2
3.3
3.4
3.5
3.6
3.7
3.8
3.9