

Bores for countersunk screw  
DIN 7991-M6  
Type **SH**



**elesa**

ELESA original design CFV.

Swivelling range

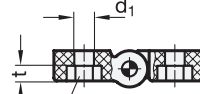
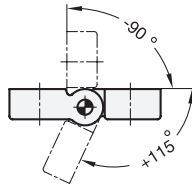

Bores for hexagon screw  
ISO 4014-M6 (SW10)  
Type **EH**

**3 Type**

- SH** 2x2 bores for countersunk screws
- EH** 2x2 bores for hexagon screws

Swivelling range with 4 indexing positions (loosening torque 3 Nm)

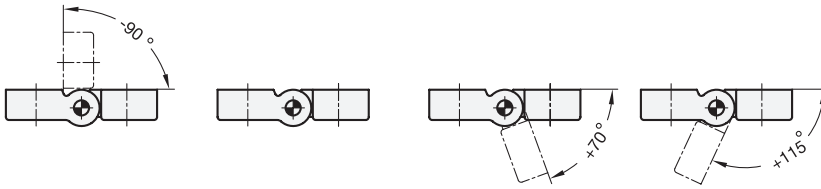

**1**

**2**

$l_1$	$l_2$	$l_3$	$d_1$	$d_2$	$h_1$	$h_2$	$h_3$	$m_1$	$m_2$	$t$
50	65	18,5	6,5	5	12	10	6	30	45	5

**Specification**

- Plastic (Polyamide PA)
  - glass fiber reinforced
  - black, matte
  - temperature resistant up to 80 °C
- Pin
  - Stainless Steel
  - German Material No. 1.4305
- *Plastic characteristics* → Page 1483
- **RoHS compliant**

**Information**

Hinges GN 222 with indexing positions are very stable and notable for a high loosening torque of 3 Nm in 4 indexing positions (test result after 20.000 detents).

Details to mechanical load bearing capacity on request.

How to order

**GN 222-50-65-SH**

- 1**  $l_1$
- 2**  $l_2$
- 3** Type