

Type A

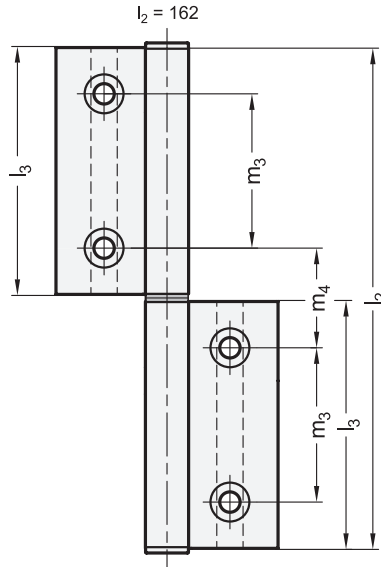

Type I

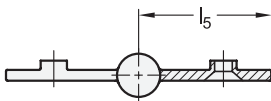
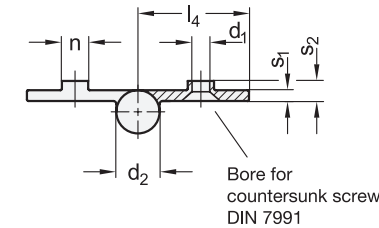

3 Type

- A Exterior hinge leaves
- I Interior hinge leaves

4 Coding

- C With countersunk holes

Assembly instruction

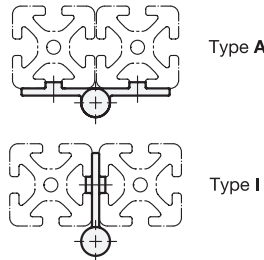

1		2															
l_1	l_2	d_1	d_2	l_3	l_4	l_5	m_1	m_2	m_3	m_4	$n - 0,3$	s_1	s_2				
Type A	Type I																
72	86	82	6,6	14	40	36	43	40,8	42	-	8	3,5	6,5				
72	86	162	6,6	14	80	36	43	40,8	-	50	8	3,5	6,5				

Specification

- Aluminum
Anodized, natural color **EL**
- Bearing bushing / Cover cap
- Plastic
Technopolymer (Polyamide PA)
- Graphite gray, RAL 7024
- Tapered dowel pin ISO 8741
Steel
Zinc plated, blue passivated
- *Plastic Characteristics* → Page 2158
- RoHS

On request

- Other lengths and hole spacings
- Other finishes

Information

Hinges GN 2292 are made of drawn profiled aluminum and are used on doors and covers, for example. The guide step allows them to be quickly and easily mounted to all commercially available profile systems with a nominal size of 40 mm and groove width "n".

Given the external hinge leaf, type A hinges allow mounting with a very small door gap. The type I is fastened in the door gap. The mounting screws are therefore inaccessible and hence protected from vandalism when the door is closed.

The hinges are delivered loose and must be mounted according to the accompanying instructions. Any hinge combination may be realized thanks to the modular design and available accessories.

How to order

1	l_1
2	l_2
3	Type
4	Coding
5	Finish

GN 2292-72-82-A-C-EL