

ELESA original design CFR.

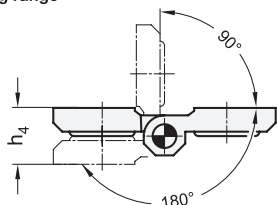

Swivelling range



Operating principle

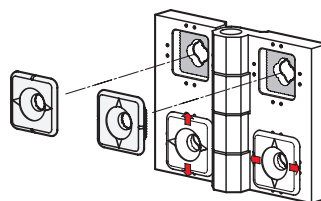

1

2

l_1	l_2	d_1	d_2	$h_1 \approx$	h_2	h_3	l_3	m_1	m_2	S_1	S_2
75	60	6,5	8	16	8	9,5	29,5	41,5	34	17	13

Specification

- Plastic (Polyamide PA)
 - glass fiber reinforced
 - black, matte
 - temperature resistant up to 80 °C
- Pin
 - Stainless Steel
 - German Material No. 1.4305
- *Plastic characteristics* → Page 1483
- *Stainless Steel characteristics* → Page 1489
- *Load rating information* → Page XYZ
- **RoHS compliant**

Information

Hinges GN 236 allow the technically and visually perfect positioning and alignment of a door in its frame.

The serrations at the wings of the hinge (cross serration) and at the adjusting bushings create a form lock which prevents the hinge from moving after installation. The tips of the arrows mark the 0 reference point for easier installation.

Depending on installation position (rotating by 90°) of the adjusting bushings, the hinge is adjustable both in vertical and in horizontal direction.

How to order

GN 236-75-60

1	l_1
2	l_2