

Swivelling range

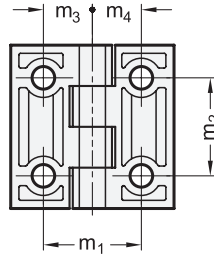

ELESA original design CFM.

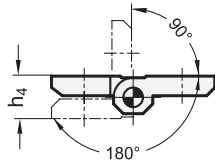

**3 Type**

- A** 2x2 bores for countersunk screws
- B** 2x2 bores for socket head cap screws
- C** 2x2 threaded studs
- D** 2x bores for countersunk screws / 2x threaded studs
- E** 2x bores for socket head cap screws / 2x threaded studs

Type A

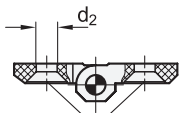

Bore for countersunk head screw DIN 7991

Type B

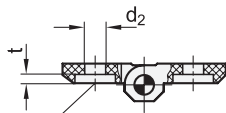

Bores for socket head cap screw with washer DIN 6912 / DIN 7984 / ISO 7092

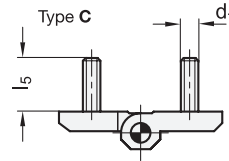

Type D

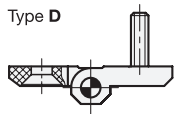

Type E

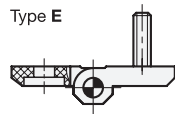

1 2

| $l_1$ | $l_2$ | $d_1$ | $d_2$ | $d_3$ | $h_1$ | $h_2$ | $h_3$ | $h_4 \approx$ | $l_3$ | $l_4$ | $l_5$ | $m_1 \pm 0,2$ | $m_2 \pm 0,2$ | $m_3$ | $m_4$ | $t$ |
|-------|-------|-------|-------|-------|-------|-------|-------|---------------|-------|-------|-------|---------------|---------------|-------|-------|-----|
| 30*   | 30    | -     | 4,5   | 2,5   | 7     | 3,5   | 4     | 8             | 10,5  | 10,5  | -     | 18            | 18            | 9     | 9     | 1,3 |
| 40    | 40    | M 5   | 5,5   | 4     | 9     | 5     | 5,5   | 11            | 14    | 14    | 12    | 25            | 25            | 12,5  | 12,5  | 1,7 |
| 50    | 50    | M 6   | 6,5   | 6     | 11,5  | 6     | 6,5   | 14            | 18    | 18    | 12    | 30            | 30            | 15    | 15    | 3   |
| 60    | 60    | M 8   | 8,5   | 8     | 15    | 8     | 8,5   | 18            | 21    | 21    | 14,5  | 36            | 36            | 18    | 18    | 3,7 |
| 63**  | 50    | -     | 6,5   | 6     | 11,5  | 6     | 6,5   | 14            | 18    | 31    | -     | 43            | 30            | 15    | 28    | -   |
| 76**  | 50    | -     | 6,5   | 6     | 11,5  | 6     | 6,5   | 14            | 31    | 31    | -     | 56            | 30            | 28    | 28    | -   |

\*only available in type A and Type B \*\*only available in type A

**Specification**

- Plastic (Polyamide PA)
  - glass fiber reinforced
  - temperature resistant up to 140 °C
  - black, matte
  - white, RAL 9002
- Pin
  - Stainless Steel AISI 303
- Threaded studs
  - Steel, nickel plated
- *Stainless Steel characteristics* → Page 1489
- *Load rating information* → Page 1462
- *Plastic characteristics* → Page 1483



• RoHS

**Information**

see also...

- *Product family Cleanline* → Page 17
- *List of hinge types* → Page 956 ff.
- *Hinges GN 237 (Zinc die casting / St. Steel / Aluminum)* → Page 959
- *Stainless Steel-Plates with tapped holes GN 2372* → Page 960
- *Stainless Steel-Spacer plates GN 2370* → Page 961
- *Rubber bumper stops GN 2374* → Page 962

How to order (black)

GN 237.1-40-40-C

- 1  $l_1$
- 2  $l_2$
- 3 Type

How to order (Cleanline)

GN 237.1-50-50-A-CL

- 1  $l_1$
- 2  $l_2$
- 3 Type
- 4 Cleanline