

Swiveling range

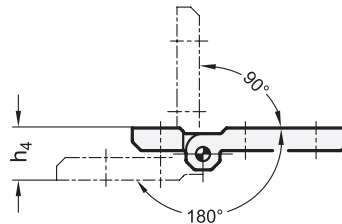
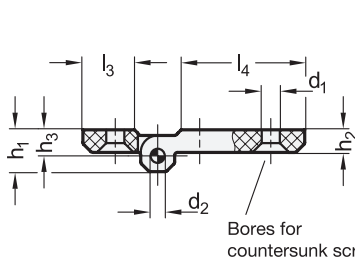

**3** Type  
AS With bores for countersunk screws

**1**

**2**

<b>1</b> l <sub>1</sub> elongated on one side	elongated on both sides	<b>2</b> l <sub>2</sub>	d <sub>1</sub>	d <sub>2</sub>	h <sub>1</sub>	h <sub>2</sub>	h <sub>3</sub>	h <sub>4</sub> ≈	l <sub>3</sub>	l <sub>4</sub>	m <sub>1</sub> ±0,25	m <sub>2</sub> ±0,25	m <sub>3</sub>	m <sub>4</sub>
64	-	40	5,5	4	9	5	5,5	11	14	38,5	25	25	20	7,5
-	88	40	5,5	4	9	5	5,5	11	38,5	38,5	25	25	20	-
77	-	50	6,5	6	11,5	6	6,5	13	18	45	30	30	25	10,5
-	104	50	6,5	6	11,5	6	6,5	13	45	45	30	30	25	-
90	-	60	6,5	8	15	8	8,5	17	21	51,5	36	36	30	12,5
-	120	60	6,5	8	15	8	8,5	17	51,5	51,5	36	36	30	-

**Specification**

- Plastic (Polyamide PA-HP)
  - Glass fiber reinforced
  - Temperature resistant up to 100 °C
  - Black, matte finish
- Pin  
Stainless steel AISI 303
- *Load Rating Information* → Page QVX
- *Plastic characteristics* → Page QVX
- *Stainless Steel Characteristics* → Page QVX
- **RoHS**

**Information**

Pointed hinges GN 237.1 feature a compact and sturdy design. The additional installation holes allow a more effective transmission of force to the mounting surface.

see also...

- *List of Hinge Types* → Page QVX
- *Hinges GN 237.1 (Plastic)* → Page QVX
- *Stainless Steel Sheet Metal Hinges GN 1364 (pointed)* → Page QVX
- *Stainless Steel Spacer Plates GN 2370* → Page QVX
- *Stainless Steel Plates with Tapped Holes GN 2372* → Page QVX
- *Rubber Bumper Stops GN 2374* → Page QVX

How to order

**GN 237.1-77-50-AS**

<b>1</b>	l <sub>1</sub>
<b>2</b>	l <sub>2</sub>
<b>3</b>	Type

