



1.1

1.2

1.3

1.4

Dimensions

The recess d_2 is only required for clamping very low parts.

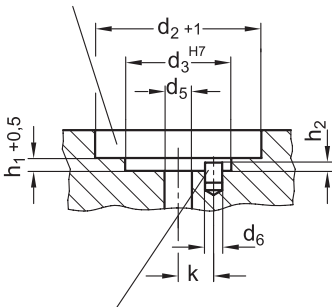

Location dowel to position the clamping segments

Operating principle

A circular ball cage containing 3 or 6 balls is forced outwards over an accurately guided cone by means of a screw which, through the exerted thrust, will enlarge the outside diameter of the circular ball cage. This in turn will lead to a firm contact between the centring clamp and bore of the workpiece.

Type K (with balls) is used for clamping applications where minute ball marks at the contact points with the workpiece are acceptable. Type S (with clamping segments) is used in such cases where marks at the clamping points on the workpiece would be acceptable.

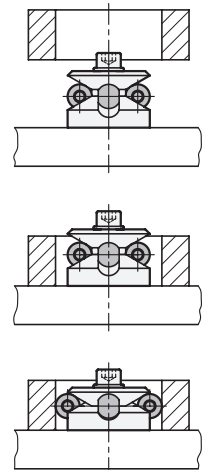

2.1

2.2

2.3

2.4

