

EDLSTÄHL® Rostfrei  
Inox  
Stainless  
Steel

**4 Type (Base plate)**

- D0** Without rubber pad
- D1** With rubber pad, clipped on, black
- D3** With rubber pad, vulcanized, black

d <sub>1</sub>	d <sub>2</sub>	I <sub>1</sub>					Version T / TK					
		Version S / SK										
50	M 8	40	50	63	-	-	-	-	-	-	-	-
50	M 10	50	60	80	100	-	-	-	-	-	-	-
50	M 12	60	80	100	125	-	-	-	-	-	-	-
50	M 16	-	-	-	-	75	100	125	150	200	250	-
60	M 8	40	50	63	-	-	-	-	-	-	-	-
60	M 10	50	60	80	100	-	-	-	-	-	-	-
60	M 12	60	80	100	125	-	-	-	-	-	-	-
60	M 16	-	-	-	-	75	100	125	150	200	250	-
80	M 8	40	50	63	-	-	-	-	-	-	-	-
80	M 10	50	60	80	100	-	-	-	-	-	-	-
80	M 12	60	80	100	125	-	-	-	-	-	-	-
80	M 16	-	-	-	-	75	100	125	150	200	250	-
80	M 20	-	-	-	-	75	100	125	150	200	250	-
80	M 24	-	-	-	-	100	125	150	200	300	-	-

**Versions of threaded stem**

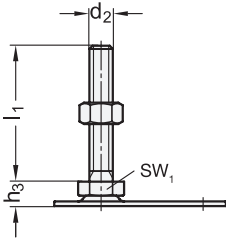

**5**  
**S** Without nut  
**SK** With nut

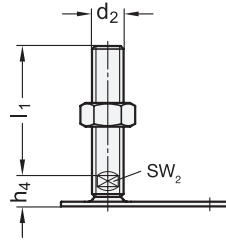

**5**  
**T** Without nut  
**TK** With nut

External hex at the bottom at  $d_2$   
 M 8, M 10, M 12

Wrench flat at the bottom at  $d_2$   
 M 16, M 20, M 24

$d_1$	$d_2$	$d_3$	$h_1$	$h_3$	$h_4$	$h_6$	$l_8$	$m$	$r$	$s$	A/F <sub>1</sub>	A/F <sub>2</sub>
50	M 8 M 10 M 12	13	2,5	11	-	4	60	45	15	2	17	-
50	M 16 - -	13	2,5	-	17	4	60	45	15	2	-	12
60	M 8 M 10 M 12	13	2,5	11	-	4,5	65	50	15	2	17	-
60	M 16 - -	13	2,5	-	17	4,5	65	50	15	2	-	12
80	M 8 M 10 M 12	13	3	12	-	5	85	70	15	2	17	-
80	M 16 - -	13	3	-	18	5	85	70	15	2	-	12
80	M 20 - -	13	3	-	19	5	85	70	15	2	-	15
80	M 24 - -	13	3	-	22	5	85	70	15	2	-	19

**Specification**

- Base plate  
Stainless steel AISI 304  
Plain, ground
- Threaded stem  
Stainless steel AISI 316L
- Hex nut ISO 4032  
Stainless Steel
- Rubber cap, clipped on  
Black, TPE (Santoprene®)  
≈ 80 Shore A
- Rubber pad, vulcanized  
Black, NBR (Perbunan®)  
70±5 Shore A
- Load Rating Information → Page 2145
- Plastic Characteristics → Page 2158
- Stainless Steel Characteristics → Page 2166
- RoHS

**Information**

Stainless steel leveling feet GN 45 are for use in aggressive environments. The range of combinations of base plates and adjustable spindle versions allows these leveling feet to be used in every situation.

The leveling feet can be screwed to the mounting surface use the fixing lug, which prevents lateral shifting. Moreover, the types with the rubber pad protect sensitive surfaces.

The leveling feet are supplied fully assembled and are not removable.

see also...

- Leveling Feet GN 40 (Steel, without Fixing Lug) → Page 1460
- Leveling Feet GN 42 (Steel, with Fixing Lug) → Page 1466 / 1468
- Leveling Feet GN 41 (Stainless Steel, without Fixing Lug) → Page 1462
- Leveling Feet GN 43 (Stainless Steel, with Fixing Lug) → Page 1470 / 1472
- Leveling Feet GN 44 (Stainless Steel, without Fixing Lug) → Page 1464
- Insert Bushings GN 992 / GN 992.5 (Aluminum / Stainless Steel, for Tubes) → Page XYZ

**How to order**

<b>1</b>	$d_1$
<b>2</b>	$d_2$
<b>3</b>	$l_1$
<b>4</b>	Type (Base)
<b>5</b>	Version (Screw)

**GN 45-50-M10-60-D3-SK**

3.1  
3.2  
3.3  
3.4  
3.5  
3.6  
3.7  
3.8  
3.9

