

### Assembly instructions

The minimum thickness for the profile suitable for use is 15 mm, while the distance between door and frame must be within 2.5 mm and 3.5 mm.

For applications with differences in height between frame and door, spacer GN 450.1 with height  $h = 5, 10$  and  $15$  mm are available.

## GN 450.1 | Spacer

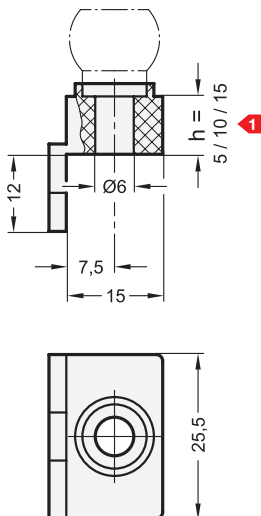

ELESA original design BPS.30-SP

### Specification

- Plastic (Polyamide PA)  
black, matte

### Information

The combination with spacers can realise the distances  $h = 20, 25$  and  $30$  mm.

How to order	1	h
<b>GN 450.1-10</b>	1	h