

GN 528.2
Bore for
countersunk screw DIN 7991

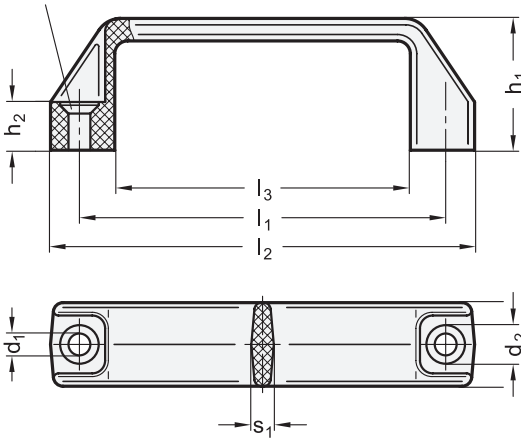

GN 528.3
Bore for
hex head screw DIN 931/ISO 4014

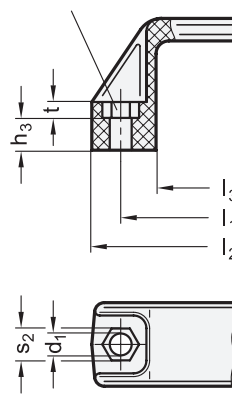

elesa
Original design M.443-SH / M.443-EH

l_1		b	d_1	d_2	h_1	h_2	h_3	l_2	l_3	s_1	s_2	t
GN 528.2	GN 528.3											
94 -1	94 -1	21	5,5	10	38	13	7	109	74	6	8	6
117 ±1	117 ±1	26	6,5	12	41	15	9	137	93	7	10	6
122 ±1	122 ±1	26	6,5	12	41	15	8,5	142	100	7	10	6,5
140 ±1	140 ±1	27	6,5	12	46	16	9,5	160	113	7	10	6,5
122 ±1	122 ±1	27	6,5	12	47	17	10,5	172	125	7	10	6,5
160 ±1	160 ±1	28	6,5	12	50	17	10,5	179	132	7	10	6,5
179 ±1	-	28	6,5	12	50	17	-	197	151	7,5	-	-

Specification

Plastic, Polyamide **PA**
 • Glass fiber reinforced
 • Operating temperature -30 °C to +130 °C
 • Black, RAL 9005, matte finish **● SW**

RoHS

see also...

	Page
GN 528 Cabinet U-Handles (Plastic, Mounting from the Operator's Side)	QVX
GN 728 Cabinet U-Handles (Aluminum, Mounting from the Back or the Operator's Side)	QVX
GN 728.5 Cabinet U-Handles (Stainless Steel, Mounting from the Back or the Operator's Side)	QVX
GN 528.1 Cabinet U-Handles (Plastic, Mounting from the Back)	QVX

Technical Information

Strength Properties	QVX
Plastic Characteristics	QVX

How to order (for countersunk screws)

GN 528.2-PA-179-SW

1	Material
2	l_1
3	Color

How to order (for hex head screws)

GN 528.3-PA-150-SW

1	Material
2	l_1
3	Color

