

Key type **CSN**

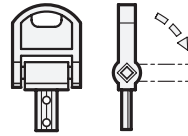

Key type **CSF**  
(Ball knob)

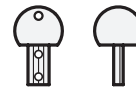

ELESA original design VLS.

**3 Type**

**CSN** with key, fold-away  
**CSF** with key, ball knob

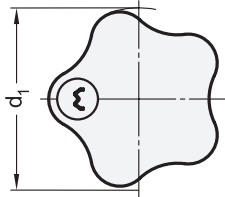

**1**

**2**

<b>d<sub>1</sub></b>	<b>d<sub>2</sub></b>	<b>d<sub>3</sub></b>	<b>h<sub>1</sub></b>	<b>h<sub>2</sub></b>	<b>h<sub>3</sub></b>	<b>t min.</b>
42	M 6	16,5	30	14,5	0,5	12
42	M 8	16,5	30	14,5	0,5	13
55	M 8	19	33	15	1	13
55	M 10	19	33	15	1	17

**Specification**

- Knob  
Plastic  
- glass fiber reinforced  
- temperature resistant up to 100 °C  
- black, matte
- Shroud flange plastic with handle core ultrasonically welded
- Indexing element plastic (Technopolymer POM)
- Threaded bushing  
Brass
- Key plastic, red  
Key profile Stainless Steel sheet
- *Plastic characteristics* → Page 1483
- **RoHS**

**On request**

- with threaded stud

**Information**

The safety star knobs GN 5337.8 have been developed for applications where access by unauthorised personnel is not permitted.

The shape of the keyhole profile (corresponding to the key profile) prevents the penetration of foreign objects.

Furthermore the safety star knob has been designed in such a way that it can also be used in outdoor areas.

The protruding part of the key type **CSN** can be folded so that the releasing and clamping operation is not impeded even with the key in the lock.

see also...

- *Safety star knobs GN 5337.9 (lockable)* → Page 409

How to order (without key)

<b>1</b>	<b>d<sub>1</sub></b>
<b>2</b>	<b>d<sub>2</sub></b>

**GN 5337.8-55-M8**

How to order (with key)

<b>1</b>	<b>d<sub>1</sub></b>
<b>2</b>	<b>d<sub>2</sub></b>
<b>3</b>	<b>Type</b>

**GN 5337.8-42-M6-CSN**

How to order (key, single)

<b>3</b>	<b>Type</b>
----------	-------------

**GN 5337.8-CSF**



1.1  
1.2  
1.3  
1.4  
2.1  
2.2  
2.3  
2.4  
3.10

**Description of function**

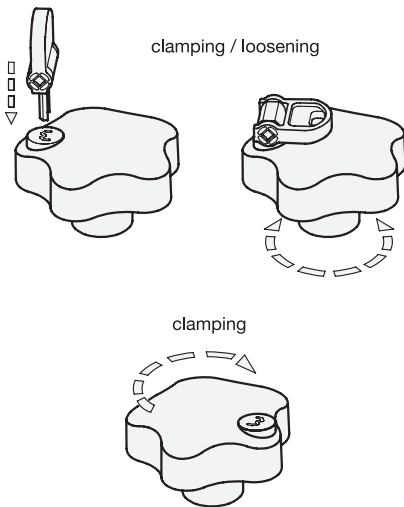

**With** key in the lock (no rotation required) the regular function of the star knob (clamping / loosening) is given.

**Without** key in the lock the star knob can only be clamped - only clockwise rotation. At anti-clockwise rotation (loosening) the indexing mechanism disrupts the knob from the threaded bushing.