

Socket cap screw
DIN 7984-M6-20

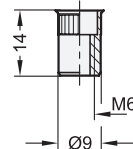

Blind rivet nut



elesa
Original design APC.

Assembly instruction

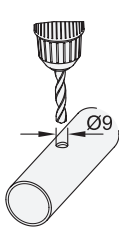

Drill the hole

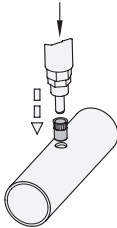

Mount the blind rivet nut

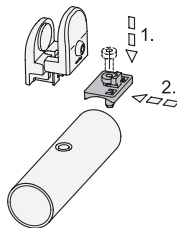

Push the adapter with the socket cap screw underneath the clamp

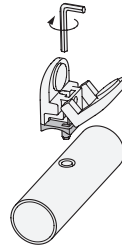

Tighten the adapter and the clamp

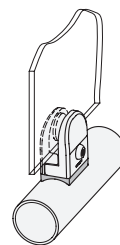

Mount the panel element



d Tube Ø from - to	Code no.
30 - 34	GN 649.1-30-34
40 - 43	GN 649.1-40-43
48 - 52	GN 649.1-48-52

Specification

- Plastic (Polyamide PA)
 - Glass fiber reinforced
 - Gray, RAL 7042, matte finish
 - Temperature resistant up to 80 °C
- Flat socket cap screw DIN 7984-M6
Steel
Zinc plated, blue passivated
- Blind rivet nut M6
Steel
Zinc plated, blue passivated
- *Plastic Characteristics* → Page 2158
- RoHS

Information

Adapters 649.1 allow panel support clamps GN 649 to be mounted to round tubes.

Mounting the M6 blind rivet nut requires a commercial blind rivet nut pliers or a setting tool.

The blind rivet nut and the flat socket cap screw DIN 7984-M6 are included parts of the order.

How to order

GN 649.1-30-34

1 d