

Component parts of assembly set:

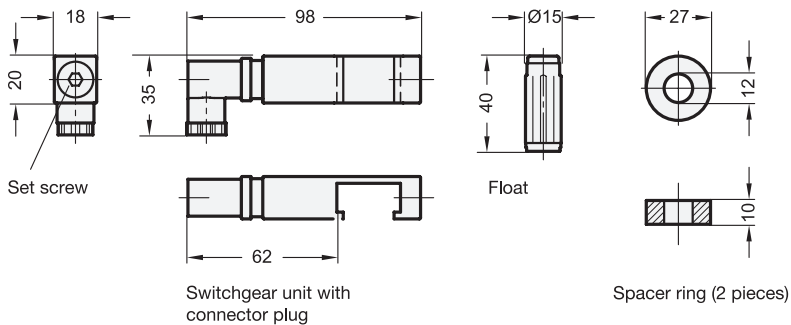

Type *)	
<b>NO</b>	1 switchgear with one contact ,normally open'
<b>NC</b>	1 switchgear with one contact ,normally closed'
<b>NO-NC</b>	2 switchgears, each of them with one contact ,normally open' and with one contact ,normally closed'
<b>NC-NC</b>	2 switchgears, each of them with one contact ,normally closed'
<b>NO-NO</b>	2 switchgears, each of them with one contact ,normally open'

\*) One float assigned to each type.

## Specification

- Switchgear unit  
Plastic (Polyamide PA)  
- Temperature resistant up to 80 °C  
- Black
- Float  
Plastic (Polypropylen PP)  
Black
- *IP Protection Classes* → Page 2153
- *Plastic Characteristics* → Page 2158
- RoHS

## Information

With the assembly sets GN 654.2, the fluid level in oil level indicators GN 654 / 654.1 can not only be viewed, it can also be monitored using an electric contact.

A float with a magnet is positioned within the indication range which closes or opens a contact at a certain fluid level (reed switch).

Depending on type, one or two switchgear units may be positioned along the visual range.

When delivered, the switchgear units are assembled such that the housing and the connector plug are on the left hand side of the oil level indicator.

Depending on mounting situation, the switchgear unit can also be mounted to the right of the contact insert of the plug in 4 positions every 90° to ensure the most favourable outgoing cable position.

How to order

**GN 654.2-NO**

1 Type

### Electrical data

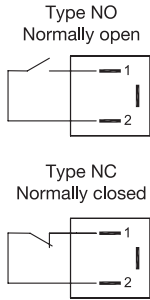

Max. switching voltage / max. switched current:	230 V AC, 230 V DC / 2 A
max. switching capacity:	40 W
Connector plug:	DIN EN 175301-803 Type C
Protection class:	IP 65
Cable gland:	PG 7, for cable-Ø from 6 up to 7 mm
Cable cross-section:	2 x 1,5 mm <sup>2</sup>

Attention: Do not mount this indicator in proximity to magnetic fields!

### Assembly sequence for the cable connection

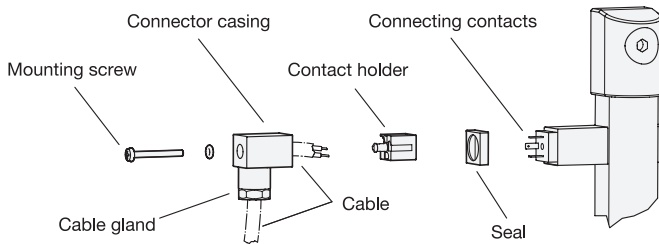

1. Loosen the mounting screw and pull off the connector plug.
2. Push the contact holder out of the connector casing.
3. Loosen the cable gland, feed the cable through the connector casing and connect it to the contact holder.
4. Push the contact holder back into the connector casing and tighten the cable gland to the strain relief / sealing of the cable.
5. Push the connector plug onto the connecting contacts of the float switch and secure in place with mounting screws.

### Assembly sequence GN 654 / GN 654.1

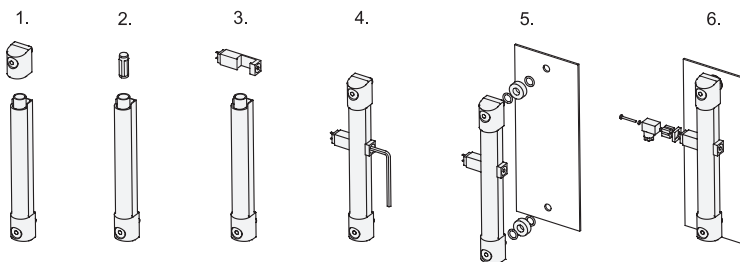

1. Remove the end piece of the oil level indicator.
2. Insert and correctly position the float with the marking „UP“ pointing up.
3. Push on the switchgear unit.
4. Fix the switchgear unit in the desired position and re-assemble the end piece.
5. Mount the oil level indicator in the reservoir wall using both plastic spacer rings if the reservoir is made of ferromagnetic material.
6. Mounting the cable connection.