

GN 666.5

Mounting from the Back

GN 666.7

Mounting from Operator's Side

Tubular Handles

Stainless Steel

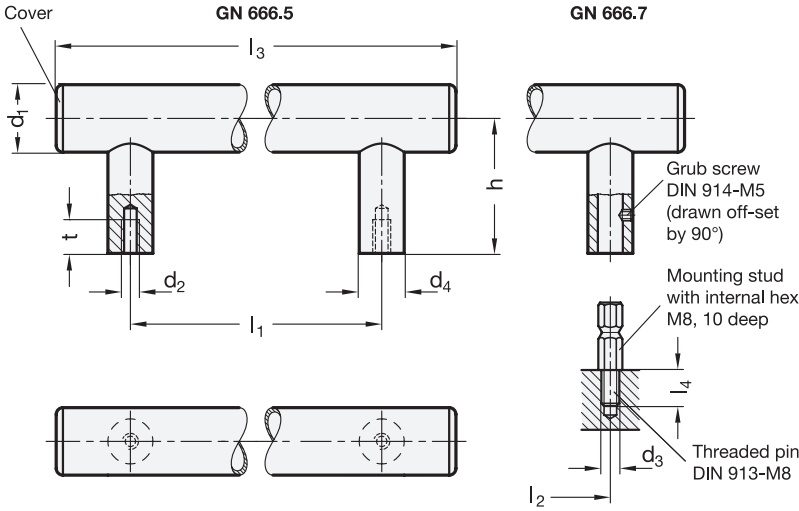

Type

- K With plastic cover
- E With stainless steel cover cap

1			2		2		3			
d ₁	d ₂ GN 666.5		d ₃ GN 666.7	l ₁ ±0,5	l ₂ ±0,3 Threaded bore for mounting stud of GN 666.7	d ₄	h	l ₃	l ₄	t min.
30	M 6	M 8	M 8	200	200	20	60	265	15	15
30	M 6	M 8	M 8	250	250	20	60	315	15	15
30	M 6	M 8	M 8	300	300	20	60	365	15	15
30	M 6	M 8	M 8	400	400	20	60	465	15	15
30	M 6	M 8	M 8	500	500	20	60	565	15	15
30	M 6	M 8	M 8	600	600	20	60	665	15	15

Specification

Handle tube
Stainless steel AISI 304, wall thickness 1,5 mm
Matte shiny finish, ground

Handle legs
Stainless steel AISI 304
Matte shiny finish, ground

Covers
• Thermoplastic elastomer (TPE) for type K
Black, matte finish
• Stainless steel AISI 304 for type E

Fastening set for GN 666.7
Stainless steel AISI 304
• Mounting stud with threaded pin DIN 913-M8
• Grub screw DIN 914-M5

RoHS

On request

- Special lengths

For a mounting of tubular handles GN 666.7 (mounting from operator's side) the stud is first screwed in from the machine side with the threaded pin DIN 913-M8x25 (included) and then the handle is pushed on and secured with the grub screw DIN 914-M5.
Type E of stainless steel tubular handles GN 666.5 and GN 666.7 is completely made of A2 stainless steel.

see also...	Page
GN 426.5 Cabinet U-Handles	QVX
GN 333.7 Tubular Handles	QVX

Technical Information	
Example of application	QVX
Load Rating Information	QVX
Plastic Characteristics	QVX
Stainless Steel Characteristics	QVX

How to order (Mounting from the Back)	1	d ₁
	2	d ₂
	3	l ₁
	4	Finish
GN 666.5-30-M6-600-E		

How to order (Mounting from Operator's Side)	1	d ₁
	2	d ₃
	3	l ₁
	4	Finish
GN 666.7-30-M8-400-K		

Mounting information

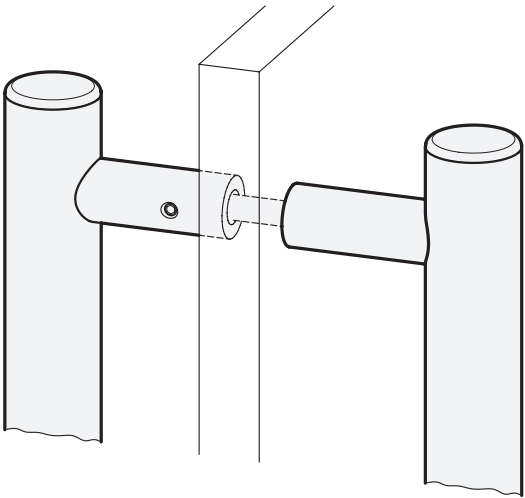

Example of application

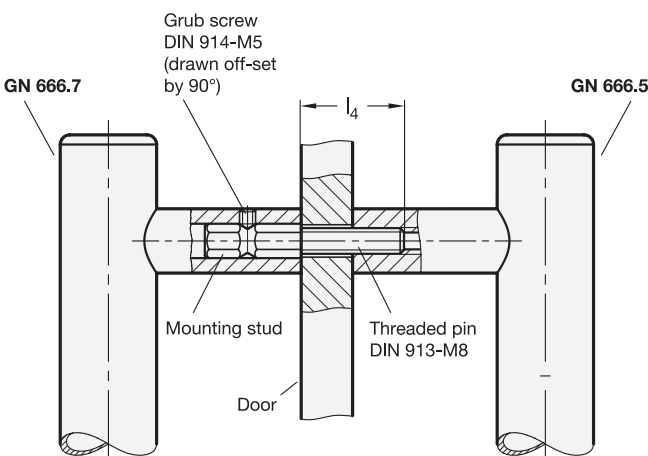

Tubular handles GN 666.5 / GN 666.7 allow the mounting of a pair of handles in opposite position. This method could be used on doors (double handle). Generally a modification of the thread length l_4 is required for this. The included threaded pin DIN 913-M8x25-A2 of the mounting stud needs to be replaced by a longer threaded pin, too. Handles with a modified thread length l_4 are available on request.