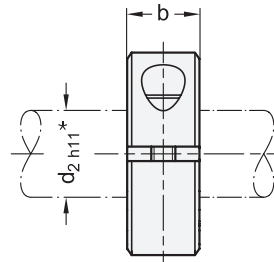
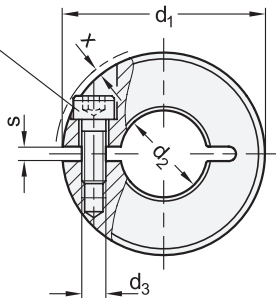

Socket cap screw  
DIN 912\* recommended  
diameter tolerance

 Rostfrei  
Inox  
Stainless  
Steel

1

2

d <sub>1</sub>	d <sub>2</sub>		AL: H10 A4: E8		b ±0,2	d <sub>3</sub>	s		x ≈ Max. protrusion of cap screw
	ST, NI: H10						ST, NI, AL	A4	
16	B 4	B 5	-	-	9	M 3	2,1	-	1,2
20	B 6	-	B 6	-	9	M 3	2,1	1,6	1,2
22	B 8	-	B 8	-	9	M 3	2,1	1,6	1
26	B 10	-	B 10	-	11	M 4	2,1	1,6	1,6
30	B 12	-	B 12	-	11	M 4	2,1	1,6	0,7
32	B 14	-	B 14	-	11	M 4	2,1	1,6	0,7
36	B 15	B 16	B 15	B 16	13	M 5	2,1	1,6	1,4
42	B 18	B 20	B 18	B 20	15	M 5	3	1,6	0,6
48	B 22	B 25	B 22	B 25	15	M 5	3	1,6	0
55	B 28	B 30	B 28	B 30	15	M 6	3	1,6	0,5
60	B 32	B 35	B 32	B 35	15	M 6	4	1,6	0,4
65	B 40	-	B 40	-	15	M 6	4	1,6	0,5

## Specification

3

- Steel
  - Sintered (Distaloy AB)
  - Black oxidised with vapor
  - Socket cap screw DIN 912
  - Steel, plain
- Stainless Steel
  - Sintered AISI 316LHC
  - Socket cap screw DIN 912-A2
  - Turned AISI 316
  - Weldable
  - Socket cap screw DIN 912-A4
- Aluminum
  - Turned, tumbled
  - Socket cap screw DIN 912-A2
- ISO Fundamental Tolerances → Page 2151
- Stainless Steel Characteristics → Page 2166
- RoHS

ST

NI

A4

AL

## Information

Semi-split shaft collars GN 706.2 can safely and simply be assembled by reducing the slot height with high clamping force and thus they act, for instance, like an end stop. The surface of the shaft or the axle is not damaged.

The thread d<sub>3</sub> for sizes d<sub>1</sub> = 16 to 36 is designed as a through hole; for sizes d<sub>1</sub> = 42 and larger, it is designed as blind hole.

see also...

- *Semi-Split Shaft Collars GN 706.4 (with Adjustable Hand Lever)* → Page 1152
- *Threaded Shaft Collars GN 706.3* → Page 1078
- *Quick Release Shaft Collars GN 704* → Page 1153
- *Shaft Collars GN 705 (with Grub Screw)* → Page 1146
- *Semi-Split Shaft Collars GN 7062.2 (Stainless Steel, with Flange Holes)* → Page 1150
- *Semi-Split Shaft Collars GN 7062.3 (Stainless Steel, with Damping Washer)* → Page 1151

## Accessory

- Damping Washers GN 7062.30 → Page 1161

How to order

GN 706.2-55-B28-NI

1 d<sub>1</sub>2 d<sub>2</sub>

3 Material