

Plunger pin protruded

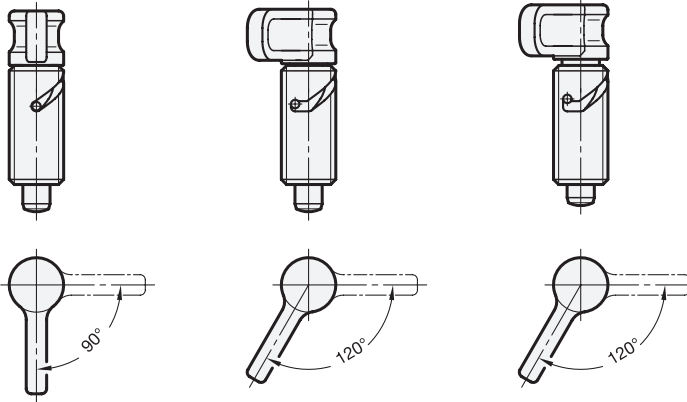

3 Type

- A** without rest position, without lock nut
- AK** without rest position, with lock nut
- R** with rest position, without lock nut
- RK** with rest position, with lock nut
- S** with safety rest position, without lock nut
- SK** with safety rest position, with lock nut

1 2

d ₁ Pin h9 Bore G7	d ₂	d ₃	l ₁ ≈	l ₂ ±0.5 Type A / AK Type R / RK	Type S / SK	l ₃ min.	l ₄	Spring load in N ≈	
								initial	end
6	M 16 x 1,5	16	60	8	6	35	32	7	16,5
8	M 16 x 1,5	16	60	8	6	35	32	7	16,5

Specification

- Steel
zinc plated, blue passivated
- Plunger pin
Stainless Steel AISI 303
- Latch
Plastic Technopolymer (Polyamide PA)
- black, matte
- not removable
- Load rating information → Page 1463
- ISO-Fundamental tolerances → Page 1479
- Stainless Steel characteristics → Page 1489
- Plastic characteristics → Page 1483
- RoHS

On request

- Stainless Steel version

Information

Cam action indexing plungers GN 712.1 are used in such applications where the plunger pin has to protrude only occasionally. When turning the cam by 90° resp. 120° degrees in clockwise direction, the plunger pin is moved through a curved opening in the body. After that, the plunger pin is protruded.

Depending on the type, the plunger pin is moved back by a spring in its original position (Type A), is held in protruded position (Type R), resp. is secured against accidental operation (Type S).

In order to move the plunger pin, safety version Type S requires an additional pushing of the latch.

see also...

- Range of cam action indexing plungers → Page 701 ff.

How to order		1	d ₁
1	2	3	GN712.1-6-M16x1,5-S
			d ₂
			Type

3.1
3.2
3.3
3.4
3.5
3.6
3.7
3.8
3.9