

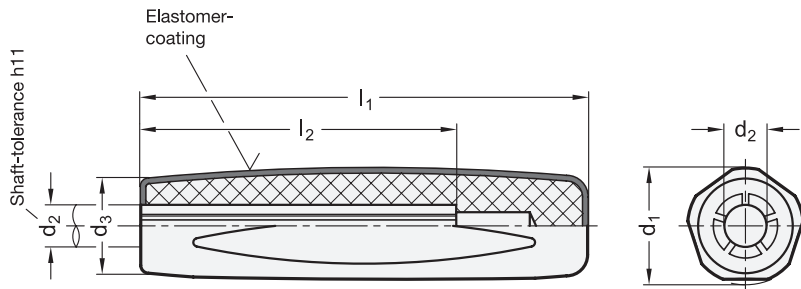



ELESA Original design EGH-SOFT



1

2

d_1	d_2 Bore B	d_3	l_1	l_2 min.
22	B 8	18	85	60

Specification

- Technopolymer (Polypropylene PP)
 - coated with a soft elastomer (TPE) 70 Shore A
 - temperature resistant up to 80 °C
 - black, matte
- Softline-coating with the plastic core chemically bonded
- ISO-Fundamental tolerances → Page 1479
- Elastomer characteristics → Page 1483
- Plastic characteristics → Page 1483
- RoHS compliant

Information

GN 819 Softline-Handle do not require a thread at the shaft.

During mounting, easy blows with a soft hammer are sufficient to drive the handle into place, the shaft end should be slightly rounded or chamfered (30°). The handle sit absolute vibration-tight.

The semi-hard plastic material makes this handle very operator friendly.

see also...

- Product family Ergostyle® → Page 17
- Product family Softline → Page 17

How to order

GN 819-22-B8

1 d_1 2 d_2