

2 Centering guide bushings
GN 870

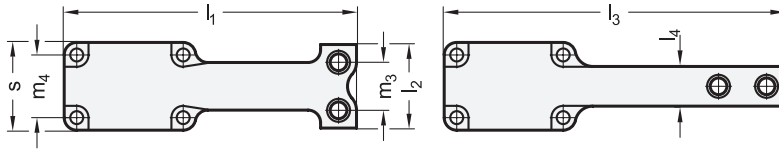

2 Type

- R** Clamping jaws at right angle to clamping arm
- P** Clamping jaws parallel to clamping arm



Mounting examples

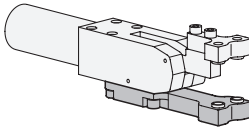

Type R

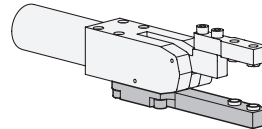

Type P

1

for power clamps Size	s -0,2	d ₁	d ₂ ^{H8/h8}	d ₃	d ₄ ^{H8/h8}	h	l ₁	l ₂	l ₃	l ₄	l ₅	l ₆	m ₁	m ₂	m ₃	m ₄
20	32	M 6	9	M 5	7	10	98,5	30	115,5	15	18,5	8	34	53	17	22
32	42	M 8	11	M 6	9	14	140	40	163	19	23,5	8,5	51	74,4	23	30
40	52	M 10	13	M 8	11	16	168	50	198	20	28	12,5	62	88,5	30	37
50	62	M 10	13	M 10	13	18	192,5	60	232,5	20	28	12,5	71,5	102	40	44

Specification

- Steel C45
Chemically nickel plated **NC**
- Socket cap screws DIN 912,
Centering guide bushings
Steel, blackened
- ISO Fundamental Tolerances → Page 2151
- RoHS

3

Information

Holders for clamping jaws GN 869.2 have been designed for use with power clamps GN 865.

Holders for clamping jaws are equally precisely positioned on the clamping arm as are the clamping jaws GN 872 on the holders themselves.

Socket cap screws and centering guide bushings are included.

see also...

- Clamping Jaws GN 872 → Page 834

How to order

GN 869.2-32-R-NC

1	s
2	Type
3	Finish

1.1
1.2
1.3
1.4
2.1
2.2
2.3
2.4

