

Assembly sets:  
2x T-nut GN 506  
2x Socket button head screw ISO 7380

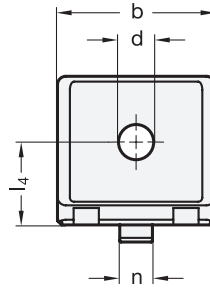

**5 Type**

- A** Without assembly set, without cover cap
- B** With assembly set, with cover cap
- C** With assembly set, without cover cap

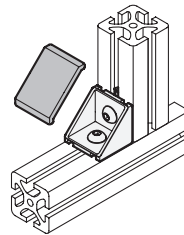
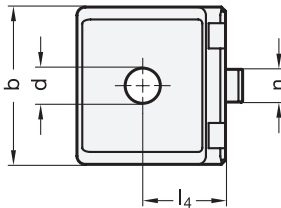

**1**

**2**

**3**

**4**

b		n	l <sub>1</sub>	l <sub>2</sub>	d	h	l <sub>3</sub>	l <sub>4</sub>	l <sub>5</sub>	s
Nominal dimension	Actual dimension									
30	28	6	30	30	6,3	2,6	3	15	6,8	5,9
40	38	8	40	40	8,5	4,1	4	20	7,2	5,6

**Specification**

- Aluminum
  - Die casting
  - Matte, tumbled
  - Powder coated
  - Black, RAL 9005, textured finish **● SW**
  - Silver, RAL 9006, textured finish **● SR**
- T-nut GN 506
  - Steel
  - Zinc plated, blue passivated
- Fillister head screw ISO 7380
  - Steel
  - Zinc plated, blue passivated
- Cover cap
  - Plastic (Polyamide PA)
  - Black, matte finish
- *Plastic Characteristics* → Page 2158
- RoHS

**6**

**Information**

To mount angle pieces GN 961 in place, first insert the nuts of the assembly sets into the profile slot, then mount the angle piece with the socket button head screws. The guide step of the nut will position them in parallel and centered to the slot; the spring element prevents inadvertent sliding.

For crossing profiles or when using the angle pieces with components without a slot, the removable guide steps can simply be snapped off.

After assembly, the cover caps are snapped into place via four lugs. They give the angle piece an attractive appearance and protect against dirt.

Even after repeated use, the cover caps will remain firmly attached to the angle pieces, thanks to the elastic snap-type lugs. If required, they are also available individually under standard GN 963 → Page 1826.

see also...

- T-Nuts GN 506 → Page 1170

**How to order**

<b>1</b>	b
<b>2</b>	n
<b>3</b>	l <sub>1</sub>
<b>4</b>	l <sub>2</sub>
<b>5</b>	Type
<b>6</b>	Finish

**GN 961-30-6-30-30-B-MT**