

Keyway P9
DIN 6885-2

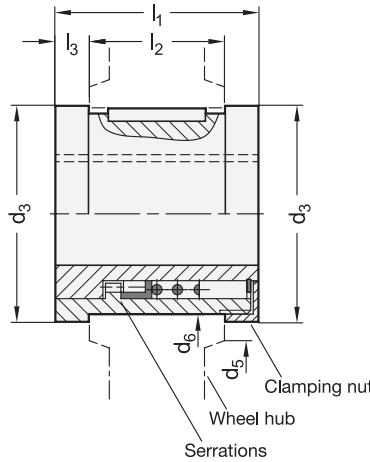

Shaft design

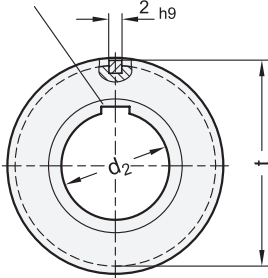
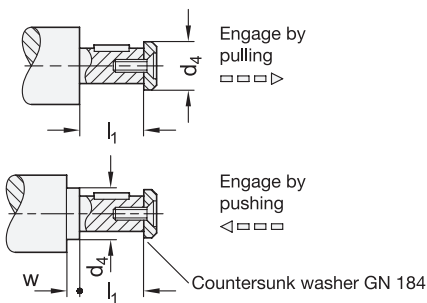

1

2

No.	d ₁ Ø Handwheel GN 321 GN 322 GN 323	d ₂ H7 Bore with keyway		d ₃	d ₄ max.	d ₅ Minimum Ø of hand- wheel hub	d ₆ -0,03 Bore Ø of hand- wheel hub H7	l ₁	l ₂ ±0,1 Length of handwheel hub	l ₃	t	w min.
1	125	K 12	-	28	17	29	25	28,5	18	5	26	4
1	140	K 12	-	28	17	29	25	28,5	19	5	26	4
2	140	K 14	K 16	32	21	33	29	32,5	19	6	30	4
2	160	K 14	K 16	32	21	33	29	32,5	20	6	30	4
3	200	K 18	K 20	38	26	39	35	36,5	24	6	36	4
4	250	K 22	-	45	30	46	41	47,5	28	12	42	4

Specification

- Steel
Nitrided
- Bearing surface ground resp.
PTFE coated
- Keyway P9 DIN 6885-2 → Page 2079
- ISO Fundamental Tolerances → Page 2151
- RoHS

Information

The PTFE coated surfaces of the coupling attachments GN 000.4 provide minimal friction between bearing surfaces even when lubrication is being neglected.

An oil hole is provided which in the completely assembled safety handwheel connects with the handwheel hub.

The coupling attachment is axially secured in the handwheel hub by a clamp nut.

see also...

- More Information to Safety Handwheels → Page 268

How to order

GN 000.4-2-K14

1	No.
2	d ₂