

**2 Lead direction**  
**RH** Right-hand thread  
**LH** Left-hand thread

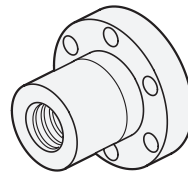

**1**

**1**

<b>d<sub>1</sub> x P</b> Single-start	<b>d<sub>2</sub> h<sub>9</sub></b>	<b>d<sub>3</sub><sup>-0.2/-0.3</sup></b>	<b>d<sub>4</sub></b>	<b>d<sub>5</sub></b>	<b>d<sub>6</sub></b>	<b>l<sub>1</sub></b>	<b>l<sub>2</sub></b>	<b>l<sub>3</sub></b>	<b>d<sub>1</sub> x Ph</b> Multi-start	<b>P<sub>T</sub></b> Pitch	Number of thread turns <b>Ph / P<sub>T</sub></b>	<b>d<sub>2</sub> h<sub>9</sub></b>	<b>d<sub>3</sub><sup>-0.2/-0.3</sup></b>	<b>d<sub>4</sub></b>	<b>d<sub>5</sub></b>	<b>d<sub>6</sub></b>	<b>l<sub>1</sub></b>	<b>l<sub>2</sub></b>	<b>l<sub>3</sub></b>
8 x 1,5	18	18	35	26	3,5	20	7	6	12 x 6*	P3	2	28	28	48	38	6	28	12	8
10 x 2	25	25	42	34	5	25	10	6	16 x 8*	P4	2	28	28	48	38	6	44	12	8
10 x 3	25	25	42	34	5	25	10	6	20 x 8*	P4	2	32	32	55	45	7	44	12	8
12 x 3	28	28	48	38	6	28	12	8	24 x 10*	P5	2	32	32	55	45	7	44	12	8
14 x 4	28	28	48	38	6	35	12	8	30 x 12*	P6	2	38	38	62	50	7	46	14	8
16 x 4	28	28	48	38	6	44	12	8	40 x 14*	P7	2	63	63	95	78	9	73	16	10
18 x 4	28	28	48	38	6	44	12	8											
20 x 4	32	32	55	45	7	44	12	8											
24 x 5	32	32	55	45	7	44	12	8											
30 x 6	38	38	62	50	7	46	14	8											
36 x 6	45	45	70	58	7	59	16	10											
40 x 7	63	63	95	78	9	73	16	10											
50 x 8	72	72	110	90	11	97	18	10											

\* For lead direction RH only

**Specification**

Gunmetal (Rg7)

**3**

**RG**

Trapezoidal lead nuts GN 103.1 are used together with trapezoidal lead screws GN 103. They can be fastened to the component to be adjusted via the bores in the flange. The centering step  $d_2$  is used to position the nut. The trapezoidal lead nuts should be lubricated to minimize wear. However, if lubrication is insufficient, the bronze alloy (gunmetal) generally has emergency running properties.

see also...

**GN 103.1** Trapezoidal Lead Nuts (Plastic, with flange)

Page

QVX

**Technical Information**

Technical Information

QVX

**Accessory**

**GN 103** Trapezoidal Lead Screws

QVX

**How to order**

<b>1</b>	<b>d<sub>1</sub> x Ph (d<sub>1</sub> x P)</b>
<b>2</b>	<b>Lead direction</b>
<b>3</b>	<b>Material</b>

**GN 103.1-24x10-RH-RG**