

Application example

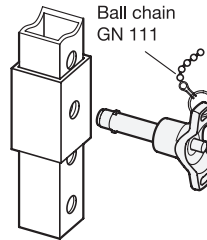

d_1 -0,1	l_1 +0,4 Minimum size													a	b	d_2	d_3	d_4	d_5	l_2	l_3	m		
6	10	12	16	20	25	30	35	40	45	50	60	70	80	-	-	2,3	0,5	7,3 +0,5	5,9	15	40	7	22	15,5
8	10	16	20	25	30	35	40	45	50	60	70	80	90	100	-	2,8	0,6	9,8 +0,5	7,9	15	40	8,4	22	15,5
10	15	20	25	30	35	40	45	50	60	70	80	90	100	110	120	3,3	1	11,7 +1	9,9	18	48	9,8	27,5	20
12	20	25	30	35	40	45	50	60	70	80	90	100	110	120	-	3,8	1	13,7 +1	11,9	18	48	11,3	27,5	20
16	30	35	40	45	50	60	70	80	90	100	110	120	130	140	150	4,8	1,2	18,7 +1	15,9	22	58	14,2	34,5	27
20	30	35	40	45	50	60	70	80	90	100	110	120	130	140	150	4,8	1,2	22,7 +1	19,8	25	58	14,8	34,5	27

Specification

Pin
Steel
Zinc plated, blue passivated

Pawl
Stainless steel sheet metal AISI 304

T-handle
Plastic, polyamide (PA)
• Black
• Operating temperature up to +80 °C
• Bushing
Stainless steel AISI 303

Push button / Slide
Plastic, polyacetal (POM)
• Push button: red
• Operating temperature up to +80 °C

Compression spring
Stainless steel AISI 302

RoHS

Accessory	Page
GN 111 GN 111.5 Ball Chains	QVX
GN 111.2 Retaining Cables	QVX
GN 111.4 Spiral Retaining Cables	QVX

Locking pins GN 114.7 with axial lock are used to quickly fix, connect and secure various components. Typically, they are used as bearing bolts that have to be frequently assembled and disassembled.

The rectangular pawls made of stainless steel sheet metal hold the locking pin in an axial position in the bore. They are retracted with the push button and when released, the compression spring returns them to the locked position. The pawls are not aligned with the T-handle.

The technical annex contains the load ratings for the double shear strength (breaking strength).

see also...	Page
DIN 172 Guide Bushings (with Collar)	QVX
DIN 179 Guide Bushings (without Collar)	QVX

Technical Information	
List of Lock Pin Types	QVX
Load Capacity	QVX
Plastic Characteristics	QVX
Stainless Steel Characteristics	QVX

How to order	1	d_1
	2	l_1

GN 114.7-10-60