

4 Type

- A** Without bores
- S** Without bores, with lubricating nipple

Swivelling range

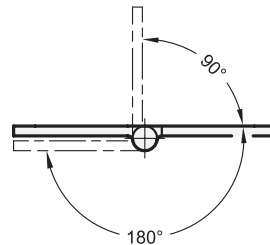

2

3

l ₁			l ₂		d	h	l ₃ ≈	s
			Type A	Type S				
60	120	160	30	-	6	12	-	5
60	120	160	40	40	6	12	21	5
60	120	160	50	50	6	12	21	5
60	120	-	60	60	6	12	21	5
160	-	-	60	60	8	15	11	6
160	200	-	80	80	8	15	11	6
160	200	-	100	100	8	16	11	7
220	-	-	100	100	13	26	21	10

Specification

1

5

- Steel profile **ST**
Rolled, scaled or drawn, plain
- Pin **BL**
Steel
- Lubricating nipple similar to DIN 71412-A Steel
Zinc plated, blue passivated
- [Load Rating Information → Page 2121](#)
- **RoHS**

On request

- With loose pin
- With brass pin
- With plain bearing bush (bronze)
- With holes
- Other dimensions
- Other finish types

Information

Hinges GN 1366 are made of rolled or drawn steel profiles and are very robust.

Types A and S are fastened by welding or using holes created by the customer. Type S also has a lubricating nipple similar to DIN 71412-A, which allows quick and easy relubrication without dismantling the hinges.

Thanks to the standard dimensions, special application-specific solutions can be realized even in relatively small quantities.

see also...

- [List of Hinge Types → Page 1284 ff.](#)
- [Hinges GN 128 \(Steel, for Welding\) → Page 1388](#)
- [Stainless Steel Hinges GN 128.2 \(for Welding\) → Page 1389](#)
- [Sheet Metal Hinges GN 136 \(Steel / Stainless Steel\) → Page 1300](#)
- [Stainless Steel Sheet Metal Hinges GN 1362 \(for Welding\) → Page 1302](#)

How to order

1	Material
2	l ₁
3	l ₂
4	Type
5	Finish

GN 1366-ST-60-50-A-BL