

GN 146.5: with 4 mounting holes

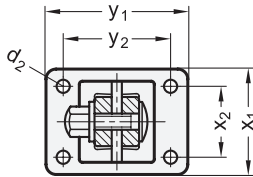

Type A
without seals

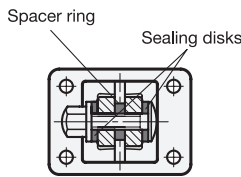

Type B
with seals

GN 146.6: with 2 mounting holes

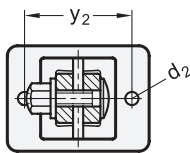

Type A
without seals

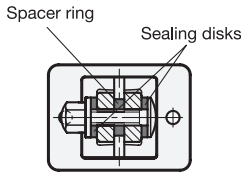

Type B
with seals

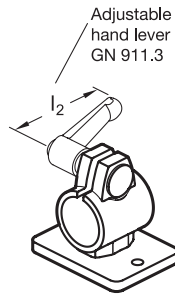
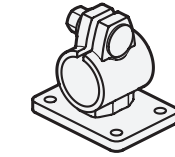

2 Type

- A** Without seals
- B** With seals

3 Identification no.

- 4** With stainless steel cap nut DIN 917



d ₁ Bore	b	d ₂	d ₃	k Clamping length	l ₁	m	t	x ₁	x ₂	y ₁	y ₂	z Screw location	Accessory		
													Recom. hand lever GN 911.3 for z	l ₂	
GN 146.5	GN 146.6														
B 30	B 30	22	6,5	37	40	66	30	7	52	35	70	53	M 8	63	78
B 50	-	30	10,7	60	65	98,5	50	9	92	62	128	98	M 10	78	92

Specification

- Stainless steel AISI CF-8
Matte shot-blasted
- Carriage bolt DIN 603
Stainless steel
- Cap nuts DIN 917 / washers
Stainless steel
- Seals
 - Sealing disks
Plastic (Polyacetal POM)
 - Spacer ring
Silicon, 40 ... 60 Shore A
- *Plastic Characteristics* → Page 2158
- *Stainless Steel Characteristics* → Page 2166
- **RoHS**

Accessory

- Adjustable Hand Levers GN 911.3 → Page 1785

Information

The clamping bores of GN 146.5 / GN 146.6 flanged connector clamps are mechanically machined and designed for construction tubings GN 990 or DIN 2391, DIN 2395 and DIN 2462 respectively.

At the screw location **z**, carriage bolt and cap nut reduce the bore cross-section for clamping. Type B is equipped with seals at the screw location.

For clamping without tools, the cap nut can be replaced by an adjustable hand lever GN 911.3 listed in the table as accessory.

How to order (With 4 mounting holes)	1	d ₁
	2	Type
	3	Identification no.
GN 146.5-B30-B-4		

How to order (With 2 mounting holes)	1	d ₁
	2	Type
	3	Identification no.
GN 146.6-B30-A-4		