

Type A
without seals

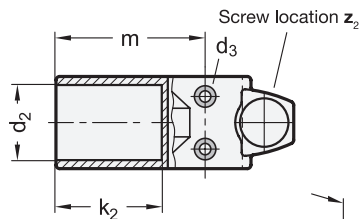

Type B
with seals

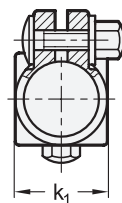
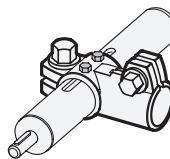
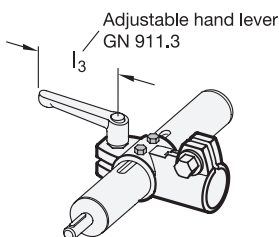

3 Type

- A Without seals
- B With seals

4 Identification no.

- 4 With 2 stainless steel cap nuts DIN 917



d ₁ Bore with sleeve bearing	d ₂ Bore	b	d ₃ Mounting screws on the drive key	k ₁ Clamping length	k ₂ Clamping length	l ₁	l ₂	m	z ₁ Screw location	z ₂ Screw location	Accessory Recom. hand lever GN 911.3			
											for z ₁ l ₃		for z ₂ l ₃	
G 30	B 30	22	M 4	37	42	96	35	60	M 8	M 8	63	78	63	78
G 50	B 50	30	M 6	65	75	151,5	48,5	103	M 10	M 10	78	92	78	92

Specification

- Stainless steel AISI CF-8
Matte shot-blasted
- Sleeve bearing
Plastic (PTFE)
- Carriage bolt DIN 603
Stainless steel
- Cap nuts DIN 917 / Washers
Stainless steel
- Seals
 - Sealing disks
Plastic (Polyacetal POM)
 - Spacer ring
Silicon, 40 ... 60 Shore A
- *Plastic Characteristics* → Page 2158
- *Stainless Steel Characteristics* → Page 2166
- RoHS

Accessory

- Adjustable Hand Levers GN 911.3
→ Page 1785

Information

T-Angle linear actuator connectors GN 192.15 are based on T-Angle connector clamps. The additionally provided mounting holes are used to connect to the drive key of a linear actuator. Bore with the designation "G" are equipped with sleeve bearings.

With the screw locations z₂, the play of the guide bore d₁ can be adjusted or the linear actuator connectors can be clamped after adjustment. Type B is equipped with seals at the screw locations.

For quick clamping without tools, the cap nuts can be replaced by the adjustable hand levers GN 911.3 listed in the table as accessories.

see also...

- *Linear Actuators GN 291* → Page 1950
- *Linear Actuators GN 292* → Page 1952
- *Linear Actuators GN 293* → Page 1953

How to order

1	d ₁
2	d ₂
3	Type
4	Identification no.

GN 192.15-G50-B50-A-4

