

Swivelling range

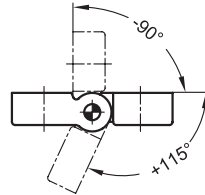

Type SH

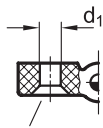

Bore for countersunk screw
DIN 7991

Type EH

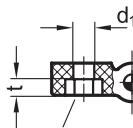

Bore for hexagon screw
ISO 4014



elasa
Original design CFV.

3 Type

- SH** 2x2 bores for countersunk screws
- EH** 2x2 bores for hexagon screws

4 indexing positions

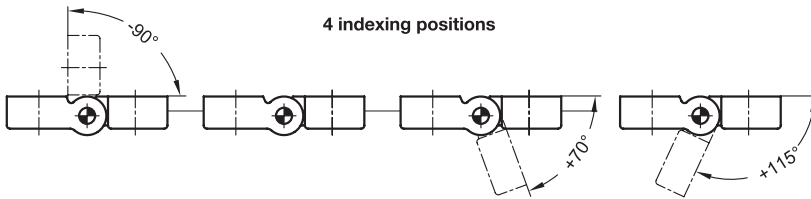

1

2

1 l_1	2 l_2	l_3	d_1	d_2	h_1	h_2	h_3	m_1	m_2	t	Max. holding torque M_H in Nm
50	65	18,5	6,5	5	12	10	6	30	45	5	3

Specification

- Plastic (Polyamide PA)
 - Glass fiber reinforced
 - Black, matte finish
 - Temperature resistant up to 80 °C
- Pin
 - Stainless steel AISI 303
- *Load Rating Information* → Page 2126
- *Plastic Characteristics* → Page 2158
- *Stainless Steel Characteristics* → Page 2166
- **RoHS**

Information

Hinges GN 222 with indexing positions are very stable and notable for a high holding torque in 4 indexing positions.

see also...

- *List of Hinge Types* → Page 1284 ff.

How to order
GN 222-50-65-SH

- 1** l_1
- 2** l_2
- 3** Type