

Version ALS

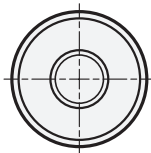

Version KT

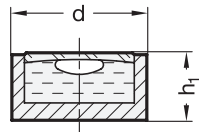
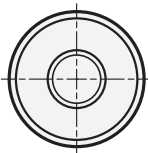
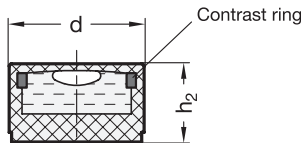

4 Sensitivity

- 10 Angle minutes,
bubble move by 2 mm
(only version ALS)
- 40 Angle minutes,
bubble move by 2 mm
(only version KT)

5 Identification no.

- 1 Without contrast ring
- 2 With contrast ring
(only version KT for d = 12...18)

2

d	h ₁	h ₂
10	6,9	6
12	6,4	7
14	6,2	8
15	7,4	8
18	7,3	9

Specification

1 3

- Housing

- Aluminum

Anodized, black

Viewing window, glass

- Plastic, white

Viewing window, transparent

● ALS

○ KT
- Filling

- Colorless-transparent

- Green-transparent
(only version KT)

K

G
- RoHS

On request

- Other sensitivities

Information

Due to their cylindrical design, bull's eye spirit levels GN 2281 are suitable for installation in plates and housings where they serve to check the horizontal position of jigs, machines and devices.

Bull's eye spirit levels are not aligned, i.e. there is no reference to the external outline of the level. The vertical position must be ensured by aligning the holding building element.

The black housing of the version ALS creates a reflection at the edge of the bubble which significantly improves the readability. Version KT is available with contrast ring inside the air level housing (Identification no. 2) which creates the same effect.

Alternatively, the contrast can also be improved by a dark surface inside the mounting bore hole.

see also...

- General Information on Bull's Eye, Screw-On and Cross Spirit Levels

→ Page 315
- Bull's Eye Spirit Levels GN 2278 (for Insertion into Bore Holes)

→ Page 319
- Bull's Eye Spirit Levels GN 2277 (with Mounting Flange)

→ Page 316
- Screw-On Spirit Levels GN 2283 (for Mounting with Screws)

→ Page 324
- Screw-On Spirit Levels GN 2282 (for Mounting with Screws)

→ Page 323

How to order	1	Material / Finish
	2	d
	3	Filling
	4	Sensitivity
	5	Identification no.
GN2281-ALS-14-K-10-1		