



**elesa**  
Original design RE.F2

**2 Bearing type**

**K** Ball bearing

**3 Type**

**A** Wheel without bracket

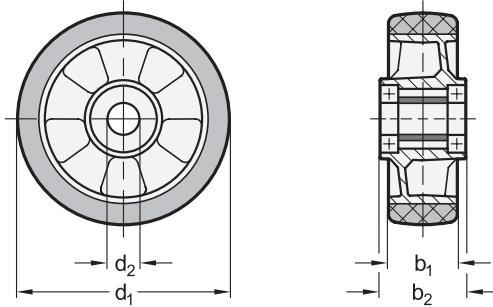

**1**

d <sub>1</sub> Wheel Ø	b <sub>1</sub>	b <sub>2</sub>	d <sub>2</sub>	Recommended ergonomic max. load in N	Max. static load capacity in N	Max. dynamic load capacity in N
100	40	40	15	3000	4000	3000
125	40	50	20	3500	5000	3500
160	50	58	20	5500	8000	5500
200	50	58	20	7000	10000	7000

**Specification**

**Wheel tread**

- Plastic, polyurethane (PUR)
- Cast
- Green
- Hardness 75 Shore A

**Wheel core**

Aluminum die casting

**Operating temperature** -20 °C to +70 °C

RoHS

Wheels GN 22886 are used in industrial and public indoor areas for moving transport carts, for example.

The wheel tread is suitable for all floor types and offers low rolling resistance and high elasticity as well as good wear and tearing resistance. It runs quietly and is gentle on floors while offering good obstacle clearing and vibration damping.

The low wear on the ball bearing increases the service life, and the mounting to the inner ring can be accomplished with zero axial backlash.

see also...

	Page
<b>GN 22886</b> Medium Duty Casters (with Bracket, Light Version)	QVX
<b>GN 22886</b> Medium Duty Casters (with Bracket, Medium Version)	QVX
<b>GN 22886</b> Heavy Duty Casters (with Bracket, Heavy Version)	QVX
<b>GN 22885</b> Wheels (ESD Version)	QVX
<b>GN 22887</b> Wheels (Wheel Core Cast Iron)	QVX

**Techni Information**

Operating Conditions of Wheels and Casters	QVX
Technical Information for Wheels and Casters	QVX
Plastic Characteristics	QVX

**How to order**

**GN 22886-125-K-A**

<b>1</b>	d <sub>1</sub>
<b>2</b>	Bearing type
<b>3</b>	Type