

**Swiveling range**

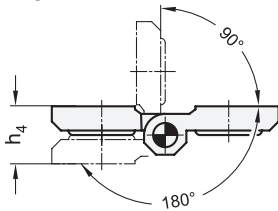

**Operating principle**

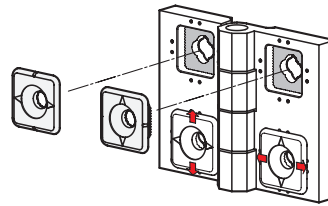

<sup>1</sup> l <sub>1</sub>	<sup>2</sup> l <sub>2</sub>	d <sub>1</sub>	d <sub>2</sub>	h <sub>1</sub> ≈	h <sub>2</sub>	h <sub>3</sub>	l <sub>3</sub>	m <sub>1</sub>	m <sub>2</sub>	s <sub>1</sub>	s <sub>2</sub>
75	60	6,5	8	16	8	9,5	29,5	41,5	34	17	13

**Specification**

- Plastic (Polyamide PA-HP)
  - Glass fiber reinforced
  - Black, matte finish
  - Temperature resistant up to 80 °C
- Pin
  - Stainless steel AISI 303
- *Load Rating Information* → Page 2126
- *Plastic Characteristics* → Page 2158
- *Stainless Steel Characteristics* → Page 2166
- RoHS

**Information**

Hinges GN 236 allow the technically and visually perfect positioning and alignment of a door in its frame.

The serrations at the wings of the hinge (cross serration) and at the adjusting bushings create a form lock which prevents the hinge from moving after installation. The tips of the arrows mark the 0 reference point for easier installation.

Depending on installation position (rotating by 90°) of the adjusting bushings, the hinge is adjustable both in vertical and in horizontal direction.

**see also...**

- *List of Hinge Types* → Page 1284 ff.
- *Hinges GN 238 (Zinc Die Casting / Adjustable)* → Page 1372
- *Hinges GN 151.4 (Plastic / Adjustable)* → Page 1377
- *Assembly Sets for Profile Systems 30 / 40 GN 965* → Page 2086
- *Assembly Sets for Profile Systems 30 / 40 / 45 GN 968* → Page 2096

How to order	1	l <sub>1</sub>
<b>GN 236-75-60</b>	<sup>1</sup>	
	<sup>2</sup>	l <sub>2</sub>