

$l_1 = 30 / 40 / 45 / 60$

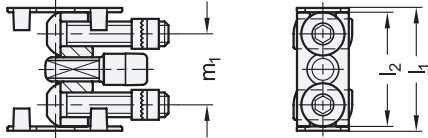

Assembly / profile machining

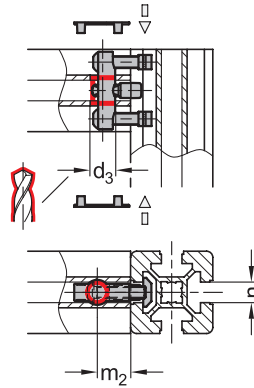

$l_1 = 80 / 90$

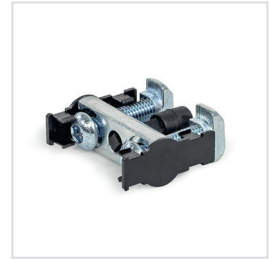
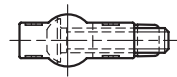
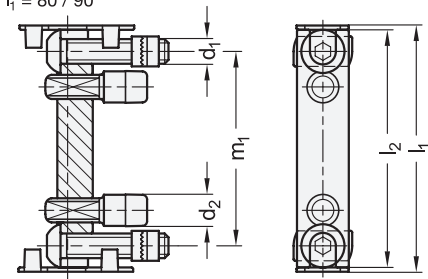

3 Type

N Nut without increased torque

4 Coding

C With fastening set

Use

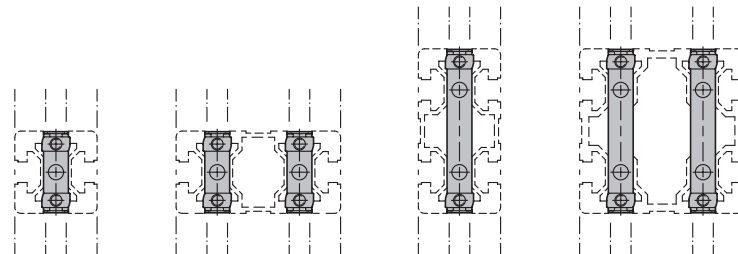

1

2

l_1 Nominal size	n	d_1	d_2	d_3	$l_2 \approx$	m_1	m_2	Tightening torque in Nm
30	8	M 5	7,3	11	29	18	18	6
40	10	M 8	10	17	37	23	22,5	25
45	10	M 8	10	17	42	28	22,5	25
60	10	M 8	10	17	57	43	22,5	25
80	10	M 8	10	17	77	63	22,5	25
90	10	M 8	10	17	87	73	22,5	25



Assembly Instructions / Profile Machining

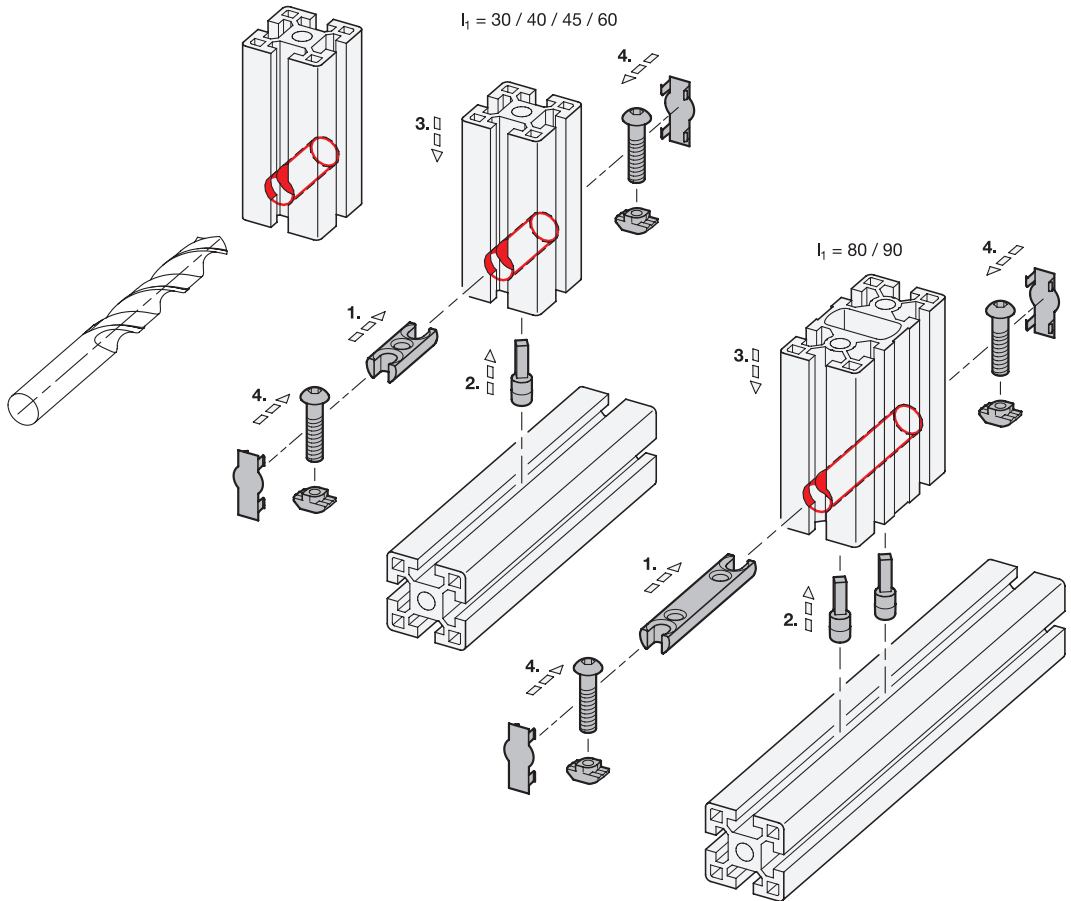

Specification



- Connector, screws, T-slot nuts
Steel, zinc plated, blue passivated **SZ**
- Cover cap
Plastic (Polyamid PA)
Black **● S**
- Guide pin
Plastic, black
- *Plastic Characteristics* → Page QVX
- **RoHS**

Information

Bolt connectors GN 26b fasten aluminum profiles at right angles and secure them against twisting. Only one profile has to be machined.

The connection can be freely positioned and slid along the slot. It is suitable for absorbing high loads, including torsional loads in particular.

The cover caps ensure a visually appealing appearance. If panels are used, they must be suitably pocketed.

see also...

- *Aluminum Profiles GN 10b (Profile Type Light)* → Page QVX
- *Aluminum Profiles GN 10b (Profile Type Heavy)* → Page QVX

How to order

1	I_1
2	n
3	Type
4	Coding
5	Material / Finish
6	Color of the cover cap

GN 26b - 90 10-N-C-SZ S