

Type OZ

Type AV

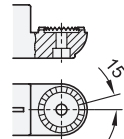

Type MZ

Type IV

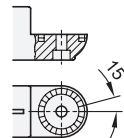
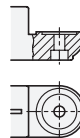

- 2 Type**
 - OZ** Without centering step (smooth)
 - MZ** With centering step
 - AV** With external serration
 - IV** With internal serration
- 3 Identification no.**
 - 2** With stainless steel socket cap screw DIN 912



d ₁ Bore	b Swivel width	d ₂	k	l ₁	m	s	t	z Screw location	Accessory recom. hand lever GN 911 for z l ₂	
B 20	40	8,5	40	95	43	13	20	M8-25	-	-
B 25	40	8,5	40	95	43	13	20	M8-25	63	78
B 30	40	8,5	40	95	43	13	20	M8-25	63	78
B 40	65	10,5	65	148	70	17	32,5	M10-50	-	-
B 42	65	10,5	65	148	70	17	32,5	M10-50	-	-
B 45	65	10,5	65	148	70	17	32,5	M10-50	78	92
B 48	65	10,5	65	148	70	17	32,5	M10-50	78	92
B 50	65	10,5	65	148	70	17	32,5	M10-50	78	92

Specification



- Aluminum
 - Powder coated
Black, RAL 9005, textured finish ● **SW**
 - Plain, matte shot-blasted finish ○ **BL**
- Socket cap screws DIN 912
Stainless steel AISI 304
- Hex nuts DIN 985
Stainless steel AISI 304
Self-locking via polyamide ring
- *Stainless Steel Characteristics* → Page 2166
- **RoHS**

Accessory

- Adjustable Hand Levers GN 911 → Page 1784

Information

The clamping bore of swivel clamp connectors GN 274 is mechanically machined and designed for construction tubes GN 990 or DIN 2391, DIN 2395 and DIN 2462.

At the screw location z, the socket cap screw reduces the bore cross-section for clamping. For clamping without tools, the socket cap screw can be replaced by an adjustable hand lever GN 911 listed in the table as accessory.

Swivel clamp connectors GN 274 can be combined with swivel clamp connectors GN 272, GN 276 or GN 278 to swivel clamp connector joints.

see also...

- *Construction Tubes GN 990* → Page 1835
- *Swivel Clamp Connector Joints GN 284 Assembly of GN 274 with GN 276* → Page 1767
- *Swivel Clamp Linear Actuator Connectors GN 274.1* → Page 1970

How to order

GN 274-B45-AV-2-BL

1	d ₁
2	Type
3	Identification no.
4	Finish