

**elesa**  
Original design TCC-AP



**2 Type**

- OZ** Without centring step (smooth)
- AV** With external serration
- IV** With internal serration

**3 Identification no.**

- 2** With stainless steel socket cap screw ISO 4762

**Type OZ**

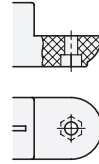

**Type AV**

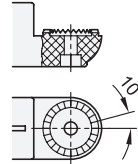

**Type IV**

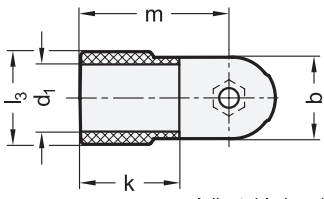
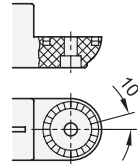

Adjustable hand lever GN 911.9

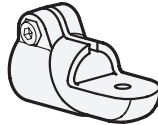

**1**

d <sub>1</sub> Bore	b Swivel width	d <sub>2</sub>	k	l <sub>1</sub>	l <sub>2</sub>	l <sub>3</sub>	m	s	t	z Screw location	Accessory Recom. hand lever GN 911.9 for z l <sub>4</sub>
B 30	40	8,5	45	88,5	54	42	67,5	13,5	20	M8-25	63 78

**Specification**

**Connector clamp**

- Plastic, Polyamide (PA)
- Glass fiber reinforced
- Operating temperature -20 °C to +100 °C
- Black, RAL 9005, matte finish
- Gray, RAL 7040, matt finish

- **SW**
- **GR**

**Socket cap screws ISO 4762**

Stainless steel AISI 304

**Hex nuts DIN 985**

Stainless steel AISI 304

Self-locking with polyamide ring

RoHS

Accessory	Page
GN 990 Construction Tubes (Aluminum / Stainless Steel)	QVX
GN 290 Adapter Bushings	QVX
GN 911.9 Adjustable Hand Levers	QVX

The fixing lug of the swivel clamp connectors GN 276.9 is available with a smooth surface or with external or internal serration. The clamping bore holds typical construction tubes with full surface contact over the entire cross-section.

At the screw location z, the socket cap screw reduces the bore cross-section for clamping. Adapter bushings GN 290 can be used to reduce the bore cross-sections to smaller diameters.

For clamping without tools, the socket cap screw can be replaced by one of the adjustable hand levers GN 911.9 listed in the table as accessories.

Swivel clamp connectors GN 276.9 can be assembled with swivel clamp connector bases GN 272.9 and swivel clamp connectors GN 278.9 to create swivel clamp connector joints.

see also...

	Page
GN 272.9 Swivel Clamp Connector Bases	QVX
GN 278.9 Swivel Clamp Connectors	QVX
GN 276 Swivel Clamp Connectors (Aluminum)	QVX

**Technical Information**

Load Rating Information	QVX
Plastic Characteristics	QVX
Stainless Steel Characteristics	QVX

How to order

1	d <sub>1</sub>
2	Type
3	Identification no.
4	Color

**GN 276.9-B30-OZ-2-SW**