

1.1
1.2
1.3
1.4
2.1
2.2
2.3
2.4

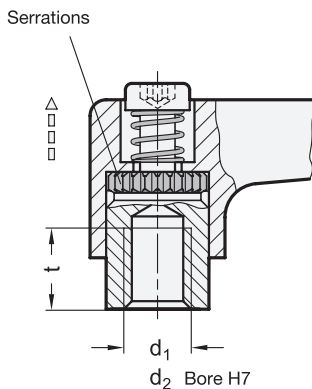
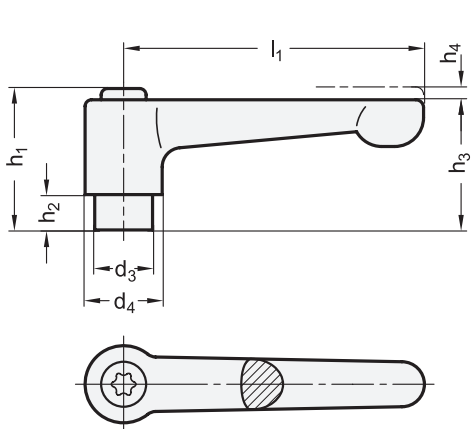

l ₁	1			2		d ₃	d ₄	h ₁	h ₂	h ₃	h ₄ Stroke	t min.
	d ₁ Thread	d ₂ Bore H7										
22	M 3	M 4	M 5	-	-	8	10,5	18,5	2	16,5	3	5
30	M 4	M 5	M 6	B 5	B 6	10	13	24,5	4	22	3,5	9
45	M 4	M 5	M 6	B 5	B 6	10	13	24,5	4	22	3,5	9
63	M 6	M 8	-	B 8	-	13,5	17,5	31	6,5	28,5	4	11
78	M 8	M 10	M 12	B 8	B 10	16	21	36	8	34	4	14

Specification

Handle

Zinc die casting
Powder coated

- Black, RAL 9005, textured finish
- Orange, RAL 2004, textured finish
- Red, RAL 3000, textured finish
- Silver, RAL 9006, textured finish

- SW
- OS
- RS
- SR

Insert / Retaining screw

Stainless steel AISI 303

RoHS

On request

With inch threads

Adjustable hand levers GN 302.1 have a straight lever, not inclined, being parallel to the clamping space.

Adjustable hand levers are ideal whenever parts have to be clamped in a confined space or in a particular lever position. The centre insert is connected to the lever via serrations which can easily be disengaged.

Pulling the lever, disengages the serrations and allowing it to be swivelled to the ideal clamping position. On releasing the lever the serrations automatically re-engage.

see also...

	Page
GN 302 Flat Adjustable Hand Levers (Insert Steel)	QVX
GN 300 Adjustable Hand Levers (Insert Steel)	QVX
GN 300.1 Adjustable Hand Levers (Insert Steel)	QVX

Technical Information

ISO Fundamental Tolerances	QVX
Stainless Steel Characteristics	QVX

How to order

GN 302.1-63-M6-SW

1	l ₁
2	d ₁ (d ₂)
3	Color