

Tolerance ring Type L

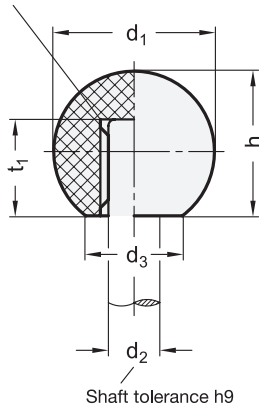

Type M

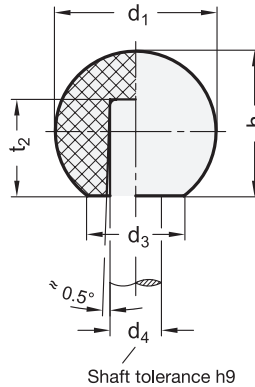

**4 Type**

- L** With tolerance ring
- M** With tapered bore

**2**

**3**

**3**

d <sub>1</sub>	d <sub>2</sub> Type L	t <sub>1</sub> Type L	d <sub>4</sub> Type M	t <sub>2</sub> Type M	d <sub>3</sub> ≈	h ≈
16	B 4	11	B 4	9	8	15
16	-	-	B 5	9	8	15
20	B 5	13	B 5	12	12	18
20	-	-	B 6	12	12	18
25	B 6	16	B 6	16	15	22,5
25	B 8	15	B 8	16	15	22,5
25	B 10	15	-	-	15	22,5
32	B 8	15	B 8	17	18	29
32	B 10	20	B 10	17	18	29
32	B 12	20	-	-	18	29
40	B 10	25	B 10	22	22	37
40	B 12	23	B 12	22	22	37
50	B 12	20	-	-	28	46
50	B 16	23	-	-	28	46

**Specification**

- Type L  
Plastic  
Duroplast (Phenolic PF)  
Black, shiny finish  
Tolerance ring  
Spring steel
- Type M  
Plastic  
Technopolymer (Polyamide PA)  
- Shock resistant  
- Black, matte finish
- ISO Fundamental Tolerances → Page 2151
- Plastic Characteristics → Page 2158
- RoHS

**On request**

- Red version

**1**

**Information**

When ball knobs DIN 319 type L and M are used the shaft does not require a thread.

During mounting, easy blows with a soft hammer are sufficient to drive the knob into place, the shaft end should be slightly rounded or chamfered (30°).

Before the assembly of the knobs, type L the tolerance ring is to be inserted into the hole. Further it is to be noted that the button is put on perpendicular and / or axially parallel. Otherwise the knob may break.

Ball knobs, type M are a more economic solution.

**KU**

**KT**

**How to order**

**DIN 319-KU-40-B10-L**

**1 Material**

**2 d<sub>1</sub>**

**3 d<sub>2</sub> (d<sub>4</sub>)**

**4 Type**