

GN 322

Rim polished

GN 324

Black, Plastic Coated

Spoked Handwheels

Aluminum

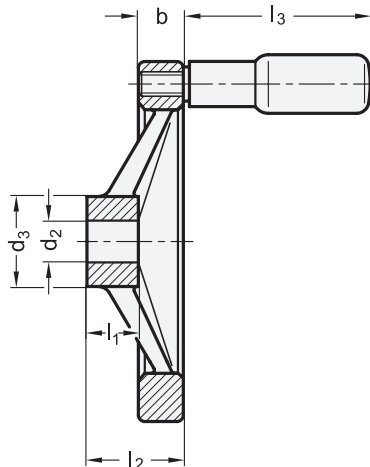
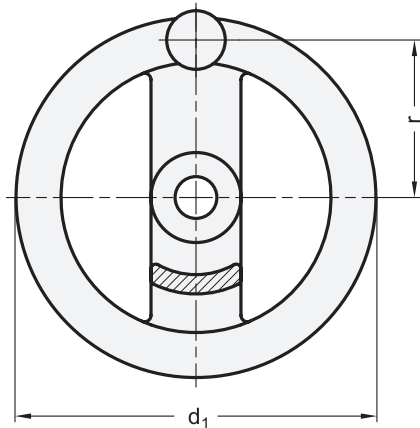

2 Bore code

- B Without keyway
- K With keyway DIN 6885-1 P9

4 Type

- A Without handle
- R With revolving handle

¹ d ₁	³ d ₂ H7 Bore		d ₃	b	l ₁	l ₂	l ₃	r	Ø Handle GN 798
125	12	14	31	15	18	33	61,5	54	22
140	14	16	36	16,5	19	36	76,5	61	24
160	14	16	36	18	20	39	76,5	71	24
200	18	20	42	20,5	24	45	86,5	89	25
250	22	26	48	23	28	51	86,5	113	25

Specification

Wheel body

Aluminum

- Hub machined
- Rim turned
- Radial and axial runout < 0,4

• GN 322

- Rim high-polished
- Unmachined body matt shot-blasted

• GN 324

- Completely powder coated
- Black, textured finish

Revolving handle GN 798

Plastic, Polyamide (PA)

- Black, matte finish
- Spindle steel
- Zinc plated, blue passivated

RoHS

Spoked handwheels GN 322 / GN 324 ...

see also...

	Page
GN 322.4 Safety Handwheels (auskuppelbar)	QVX
GN 924 Spoked Handwheels (Aluminum, plastic coated)	QVX

Technical Information

Keyway P9 DIN 6885-1	QVX
Cross holes GN 110	QVX
ISO Fundamental Tolerances	QVX

Accessory

GN 184 Countersunk Washers (for Axial Fastening)	QVX
---	-----

How to order (rim polished)

¹ ² ³ ⁴
GN 322-140-K14-R

1	d ₁
2	Bore code
3	d ₂
4	Type

How to order (plastic coated)

¹ ² ³ ⁴
GN 324-200-B20-A

1	d ₁
2	Bore code
3	d ₂
4	Type