

Type T1  
Button with LED ring lighting  
red or green depending on the polarity

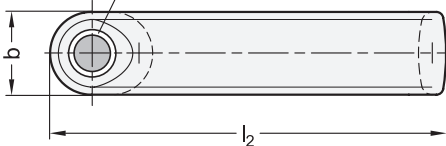

Type T2

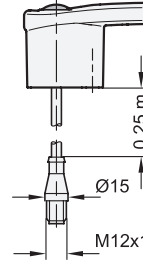
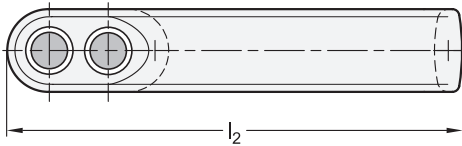

Connection type S

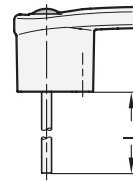

Connection type K



2 Type

- T1 With 1 button
- T2 With 2 buttons

3 Connection type

- K Cable
- S Plug (with 0,25 m cable)

l <sub>1</sub> ±0,2	l <sub>2</sub>		l <sub>3</sub>	a	b	d	h	t	Cable length l <sub>4</sub> in meter	
	Type T1	Type T2							Connection type K	
117	158	181,5	105,5	10,2	33	M 6	44	12	2	5

Specification

Handle

Zinc die casting  
Powder coated

- Black, RAL 9005, textured finish ● SW
- Silver, RAL 9006, textured finish ● SR

Button

Stainless steel AISI 304

Cable (Outer sheath)

Polyurethan PUR  
Black

Light guide

Plastic  
Crystal-clear Polycarbonate (PC)

RoHS

Technical Information

Page

Electrical and Mechanical Properties	QVX
Load Rating Information	QVX
Plastic Characteristics	QVX

Accessory

GN 330 Cables with Connector Coupling (5-pole, 5 or 10 meters long)	QVX
---	-----

Cabinet U-handles GN 422 come with one or two push buttons. Each button has a changeover switch and integrated LED ring lighting. When the button is pressed, an electrical control impulse to switch off a machine, for example, can be triggered based on the wiring of the contacts (NC or NO).

Independent whether or not the button is actuated, the integrated LED ring lighting shines either red or green depending on the polarity of connections 1 and 2 of the LED.

The cabinet U-handle is functional and highly compact and can be used for any application due to its universal design.

see also...

	Page
GN 422.1 Cabinet U-Handles (Aluminium)	QVX
GN 628.4 Cabinet U-Handles (Plastic, with Power Switching Function)	QVX
GN 331 Tubular Handles (with Power Switching Function)	QVX

How to order (With plug)

1 2 3 4  
**GN 422-ZD-T2-S-SR**

1 Material

2 Type

3 Connection type

4 Finish

How to order (With cable)

1 2 3 4 5  
**GN 422-ZD-T1-K-5-SW**

1 Material

2 Type

3 Connection type

4 Cable length l<sub>4</sub>

5 Finish

1.1  
1.2  
1.3  
1.4  
2.1  
2.2  
2.3  
2.4

Electrical and Mechanical Properties		
<b>Button</b> Contacts Contact material Switching voltages  Switching current mechanical lifespan electrical lifespan	Changeover contact, snap contact Silver alloy max. 125 V (plug) max. 240 V (cable)  max. 3 A 10 <sup>6</sup> switching cycles 50,000 switching cycles (under full load)	
<b>LED ring lighting</b> Operating voltage / Operating current bi-color (red / green)	24 V DC ± 10 % / 7 mA	
<b>Category of use (button)</b>	AC 15: 24 V AC / 1 A / DC 13: 24 V DC / 0.7 A AC 15: 110 V AC / 1 A / DC 13: 110 V DC / 0.2 A AC 15: 220 V AC / 0.5 A / DC 13: 220 V DC / 0.1 A	according to IEC 60947-5-1
	AC: 120 V AC / 5 A / DC: 12 V DC / 1 A AC: 240 V AC / 3 A	according to UL 508
<b>Connection type</b> Cable (K) or Plug connector (S)	PUR cable with open stranded wires (2 m or 5 m)  5-pin connector M12x1 with PUR cable 0.25 m	Pin configuration and cable assignment <ul style="list-style-type: none"> <li>1 - green</li> <li>2 - white</li> <li>3 - yellow</li> <li>4 - gray</li> <li>5 - brown</li> </ul>
<b>Approvals, conformities</b> CE declaration		

**Installation Holes**

The holes must be free of burrs to prevent damage to the cable.

