

Bore for socket cap screw
DIN 912-M5 / M6

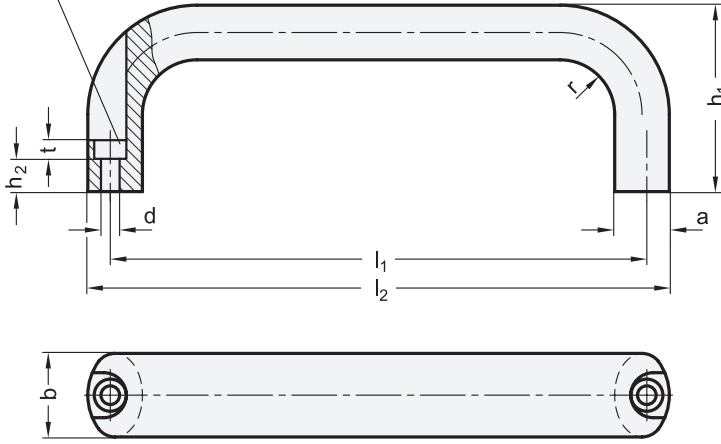

1.1

1.2

1.3

1.4

1

2

b	l ₁ ±0,25	a	d	h ₁	h ₂	l ₂	r	t
20	100	13	5,4	49	13,5	112	13	5,5
20	112	13	5,4	49	13,5	124	13	5,5
20	117	13	5,4	49	13,5	129	13	5,5
20	120	13	5,4	51	13,5	132	13	5,5
20	128	13	5,4	51	13,5	140	13	5,5
20	160	13	5,4	51	13,5	172	13	5,5
26	116	17	6,4	55	11	130	17	6
26	120	17	6,4	55	11	134	17	6
26	132	17	6,4	55	11	146	17	6
26	164	17	6,4	57	11	178	17	6
26	179	17	6,4	57	11	193	17	6
26	196	17	6,4	57	11	210	17	6

2.1

Specification

3

- Aluminum
 - Powder coated
 - Black, RAL 9005, textured finish ● **SW**
 - Red, RAL 3000, textured finish ● **RS**
 - Silver, RAL 9006, textured finish ● **SR**
 - Anodized, natural color ● **EL**
 - Plain, tumbled ○ **BL**
- Load Rating Information → Page 2106
- RoHS

Information

Cabinet U-handles GN 565.1 are manufactured from a bent aluminum profile and have excellent stability and ergonomic design.

In addition to the standard surfaces, these cabinet U-handles are also available with a functional coating.

The **SW** version is coated with a highly weather-resistant and UV-resistant powder coating system, making this version excellent for outdoor use.

see also...

- Cabinet U-Handles GN 565.5
(Stainless Steel, Mounting from the Back or the Operator's Side) → Page 108

- Assembly Sets for Profile Systems 30 / 40 GN 965 → Page 2086
- Assembly Sets for Profile Systems 30 / 40 / 45 GN 968 → Page 2096

How to order

GN 565.1-26-132-SW

1	b
2	l ₁
3	Finish



2.4

2.2