

Identification no. 1

Identification no. 2

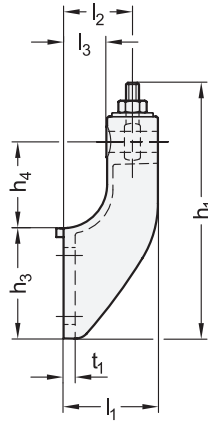

**elesa**  
Original design SPF.V / SPF.D

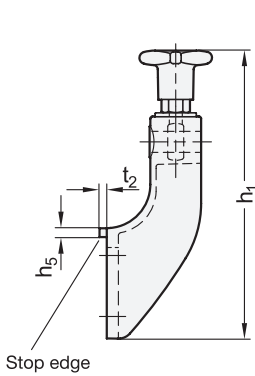
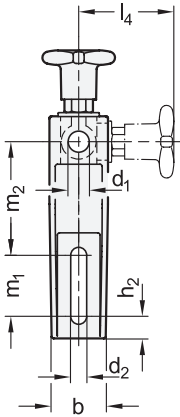

**1 Identification no.**

- 1 With hand knob
- 2 Without hand knob

**Application example**

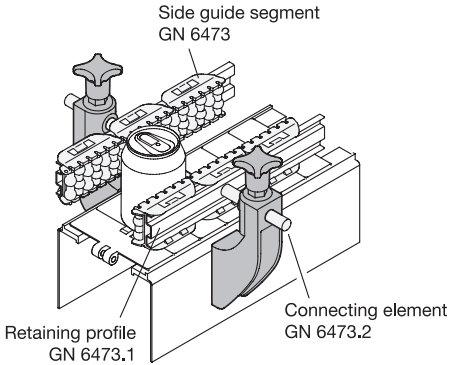

Identification no. 1

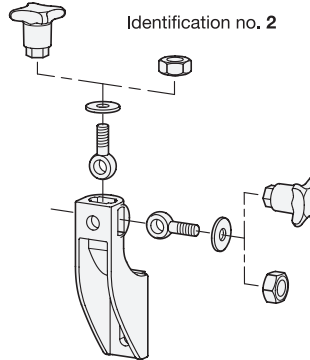

<b>d<sub>1</sub></b>			<b>h<sub>1</sub></b>		<b>b</b>	<b>d<sub>2</sub></b>	<b>h<sub>2</sub></b>	<b>h<sub>3</sub></b>	<b>h<sub>4</sub></b>	<b>h<sub>5</sub></b>	<b>l<sub>1</sub></b>	<b>l<sub>2</sub></b>	<b>l<sub>3</sub></b>	<b>l<sub>4</sub></b>	<b>m<sub>1</sub></b>	<b>m<sub>2</sub></b>	<b>t<sub>1</sub></b>	<b>t<sub>2</sub></b>
D 12	D 14	D 16	Id. no. 1	Id. no. 2														
D 12	D 14	D 16	198	173	37	11	15	76	60	4	65	47	30	63	42	79	8	2,5

**Specification**

**Bracket**

- Plastic, polyamide (PA)
- Glass fiber reinforced
- Operating temperature -30 °C to +100 °C
- Black, matte finish

**Hand knob (identification no. 1)**

- Plastic, polyamide (PA)
- Glass fiber reinforced
- Black, matte finish
- Threaded bushing, brass

**Hex nut (identification no. 2)**

Stainless steel AISI 304

**Swing bolt / Washer**

Stainless steel AISI 304

RoHS

**Technical Information**

	Page
Plastic Characteristics	QVX
Stainless Steel Characteristics	QVX

Side guide brackets GN 6476 fasten side guides or side guide segments to conveyor sections. This also requires the use of connecting elements GN 6473.2, retaining profiles GN 6473.1 or side guide clamps GN 6475.3, GN 6475.4 or GN 6475.5.

The stop edge facilitates horizontal alignment on the conveyor system. The swing bolt with the hand knob or the hex nut can be attached to the side guide bracket either on top or on the side to respond to different space conditions.

**see also...**

	Page
<b>GN 6471</b> Side Guides (Cylinder and Ball Rollers on One Side)	QVX
<b>GN 6472</b> Side Guides (Cylinder and Ball Rollers on Two Side)	QVX
<b>GN 6473</b> Side Guide Segments (Cylinder and Ball Rollers on One Side for Curves)	QVX
<b>GN 6473.2</b> Connecting Elements	QVX

**How to order**

**GN 6476-1-D12-198**

1	Identification no.
2	d <sub>1</sub>
3	h <sub>1</sub>