

Electrical data

Max. switching voltage / max. switched current:	230 V AC, 230 V DC / 2 A
max. switching capacity:	40 W
Connector plug:	DIN EN 175301-803 Type C
Protection class:	IP 65
Cable gland:	PG 7, for cable-Ø from 6 up to 7 mm
Cable cross-section:	2 x 1,5 mm ²

Attention: Do not mount this indicator in proximity to magnetic fields!

Assembly sequence for the cable connection

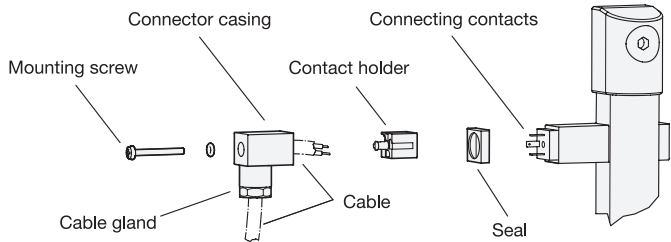

1. Loosen the mounting screw and pull off the connector plug.
2. Push the contact holder out of the connector casing.
3. Loosen the cable gland, feed the cable through the connector casing and connect it to the contact holder.
4. Push the contact holder back into the connector casing and tighten the cable gland to the strain relief / sealing of the cable.
5. Push the connector plug onto the connecting contacts of the float switch and secure in place with mounting screws.

Assembly sequence GN 654 / GN 654.1

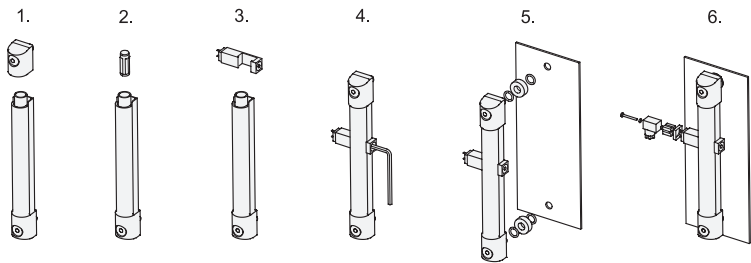

1. Remove the end piece of the oil level indicator.
2. Insert and correctly position the float with the marking „UP“ pointing up.
3. Push on the switchgear unit.
4. Fix the switchgear unit in the desired position and re-assemble the end piece.
5. Mount the oil level indicator in the reservoir wall using both plastic spacer rings if the reservoir is made of ferro-magnetic material.
6. Mounting the cable connection.