

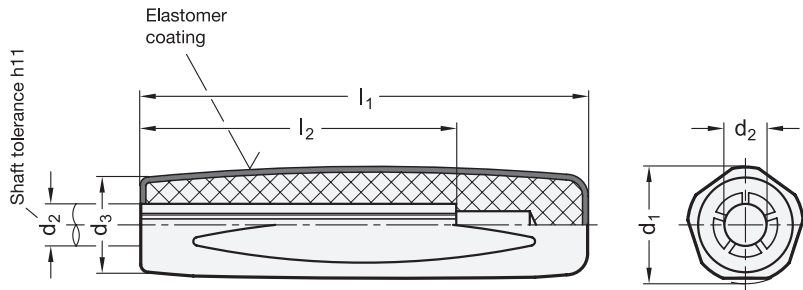

elesa
Original design EGH-SOFT



1

2

d_1	d_2 Bore	d_3	l_1	l_2 min.
22	B 8	18	85	60

Specification

- Base body
Plastic
Technopolymer (Polypropylen PP)
- Softline coating
 - Elastomer (TPE) 70 Shore A
 - Chemically bonded with base body
 - FDA compliant plastic granulate
 - Temperature resistant up to 80 °C
 - Black, matte finish
- ISO Fundamental Tolerances → Page 2151
- Plastic Characteristics → Page 2158
- RoHS

Information

The handle GN 819 does not require a thread at the shaft.
 During mounting, easy blows with a soft hammer are sufficient to drive the handle into place, the shaft end should be slightly rounded or chamfered (30°). The handle sits absolute vibration-tight.
 The softline coating makes the handle particularly user-friendly and ergonomic.

see also...

- Product Family Ergostyle® → Page 18
- Product Family Softline → Page 18

How to order

GN 819-22-B8

1	d_1
2	d_2