

2 Type
AS Sheet metal body



Size	F_H in N Holding capacity	a	b	d_1	d_2	d_3	$h_1 \approx$	h_2	$l_1 \approx$
120	3600	17	48	12	M 6	5,5	111	31	130
300	7200	20	58	14	M 8	6,5	140	36	167

Size	$l_2 \approx$	$l_3 \approx$	$l_4 \approx$	m_1	m_2	m_3	A/F	t	w Stroke
120	121	40	30	34	30	17	24	12	20
300	155	57	45	50	34	18	27	16	34

Specification

- Sheet metal parts
Case-hardened steel C10
Zinc plated, blue passivated
- Plunger
Steel St 37
Zinc plated, blue passivated
- Guide bushing
Brass
Zinc plated, blue passivated
- All moving parts
Lubricated with special grease
- RoHS

Accessory

- Clamping Screws → Page 810 ff.

Information

see also...

- General Information for Toggle Clamps → Page 698

How to order

GN 841-120-AS

1 Size

2 Type

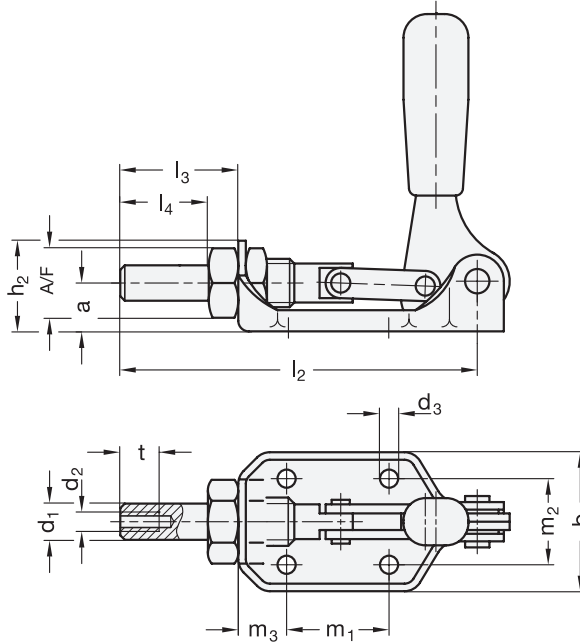

1.1

1.2

1.3

1.4

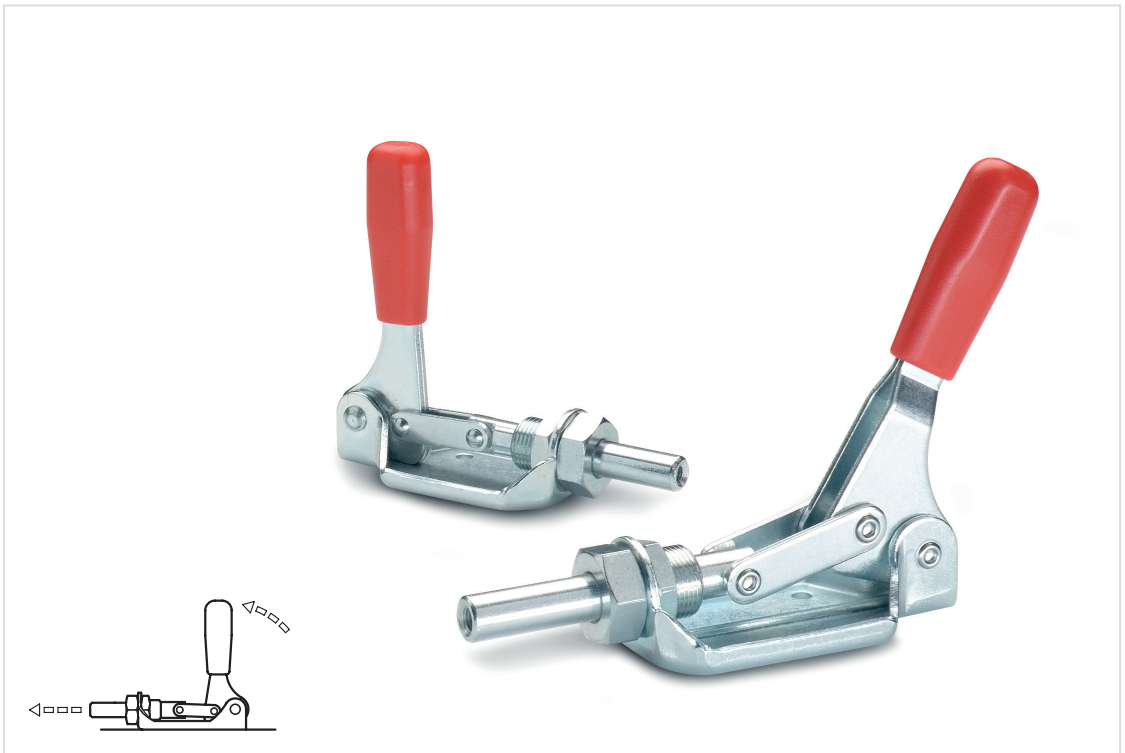

2.1

2.2

2.3

2.4

