

STAIN
LESS
**

2 Type

- T With draw axle
- TF With draw hook

Type T

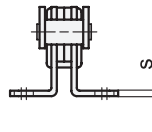
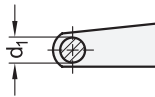

Type TF

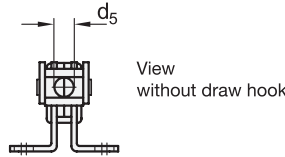
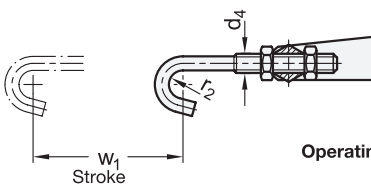

Operating principle

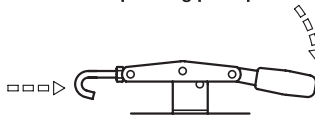

1

Size	F _H Holding capacity in N	a ₁	a ₂	b ₁	b ₂	b ₃	d ₁	d ₂	d ₃	d ₄	d ₅	h ₁ ≈
160	1400	30	25	35	42	14	8	5,5	5,2	M 6	6,3	40
220	2400	37	29	41	45	18	10	6,5	7,1	M 8	8,3	49
320	3600	35	25	48	60	21	10	8,5	8,8	M 10	10,3	49
420	4800	44	34	54	84	26	14	10,5	8,8	M 10	10,3	60,5

Size	h ₂	l ₁ ≈	l ₂ ≈	l ₃ ≈	m ₁	m ₂	m ₃	r ₁ ≈	r ₂	s	W ₁ Stroke	W ₂ ≈ Adjustable range
160	13	176	44	81	16	27,5	28,5	85	3,2	2,5	87	20
220	16	200	51	95	19	31,5	32,5	99	5	3	97	21
320	20	225	51	97	32	44,5	45,5	105	6	3	100	23,5
420	25	275	58	107,5	28,5	59,75	61,25	138	6	5	155	19,5

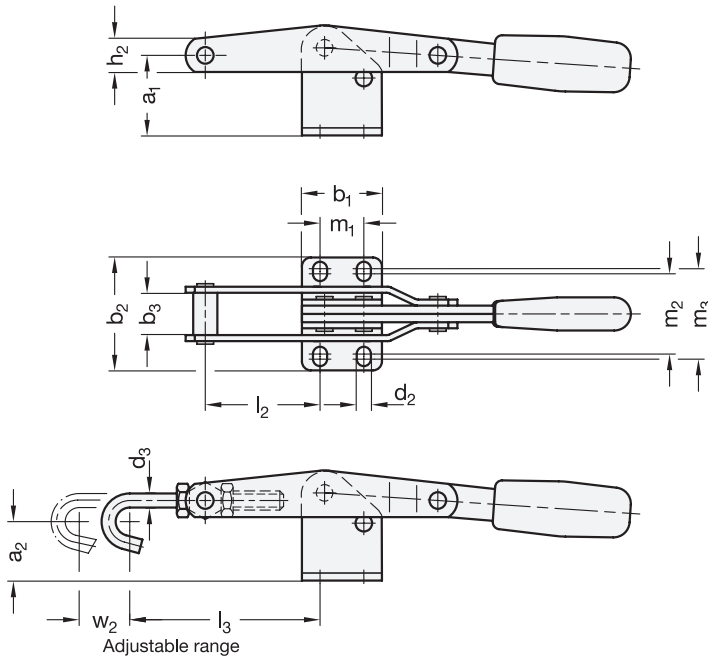

Specification

Tensioning mechanism

- Steel **ST**
- Sheet metal parts
- Case-hardened steel C10, zinc plated, blue passivated
- Bearing pins tempered
- Bearing rivets case hardened
- Stainless steel AISI 304 **NI**
- Moving parts lubricated with special grease

Draw hook

- Steel St 37 for ST
- Zinc plated, blue passivated
- Stainless steel AISI 301 for NI

Handle

- Plastic
- Red, oil resistant

RoHS

On request

- without draw hook (Type TFN)

Latch type toggle clamps GN 850 are suited for rapid closing and fastening of lids, covers and molds.

During clamping, the pivoting motion of the clamping lever is transformed into an axial movement of the draw axle or draw hook and ensures a form-fit hold.

Latch type toggle clamps of type T are equipped with a draw axle firmly attached to the clamping arm. Type TF has a draw hook that can be adjusted within the adjustable range w_2 . The draw hook is supplied unmounted.

see also...

	Page
GN 850.1 Latch Type Toggle Clamps	QVX
GN 851 Latch Type Toggle Clamps	QVX

Technical Information

Operating Principle Toggle Lever / Overview of Toggle Clamp Types	QVX
Stainless Steel Characteristics	QVX

How to order

GN 850-220-TF-ST

1	Size
2	Type
3	Material

