

GN 900.1

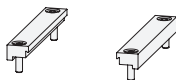

GN 900.2

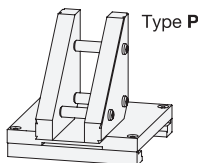
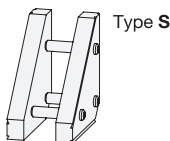
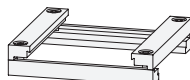

The outer slide is made of a press formed block of anodized Aluminum extrusion which is usually the moving part.

As a standard there is usually one outer slide size for each outside slide length on which the connecting sets GN 900.2 and mounting plates GN 900.4 and rotary plates GN 900.5 can be mounted.

Special lengths can be supplied.

The inner slide is also made of a press formed block of anodized Aluminum extrusion which is the carrier. The guides are made of two high grade shafts in stainless steel.

High load ratings and favourable friction values is achieved by the anodized hard guide surfaces.

The length of the inner slide is determined by the length of the outer slide by adding the stroke.

The backlash free drive unit consists of an end plate and a preloaded stainless steel spindle, ball bearing mounted, and a preloaded plastic nut (temperature resistant from - 20 °C up to + 80 °C).

The thread pitches are:

Slide size  $b = 30$ : 0,5 mm

Slide sizes  $b = 50, 80, 120$ : 1,0 mm

Die Positionierung erfolgt mit Hilfe einer Skala (ein Teilstrich = 0,05 mm Verstellweg), die auf „0“ gesetzt werden kann.

Permissible load values of the adjustable slide units GN 900:

b	F <sub>1</sub> in N	F <sub>2</sub> * in N	F <sub>3</sub> in N	M <sub>1</sub> in Nm	M <sub>2</sub> in Nm	M <sub>3</sub> in Nm
30	150	40	65	2	2	1
50	300	120	215	4	5	3
80	500	150	365	8	10	6
120	1000	300	700	15	20	12

\* F<sub>2</sub> is the max. permissible sliding thrust

Fastening units GN 900.1 consist to two mounting rails. On the latter, the adjustable slide unit is mounted on a base plate from the operator's side.

Connecting sets GN 900.2 consist of four rails. With the latter, two adjustable slide units are combined to form an adjustable assembly X - Y (or Y - Z).

Connecting sets GN 900.3 consist of two plates. With the latter two adjustable slide units combined to form an adjustable assembly X-Z (or Y-Z). If this slide has to be parallel to the reference axis this is achieved by using an additional plate (Type P).

Mounting plates GN 900.4 serves as an adaptor plate to be machined on the side which is required for mounting. By using a machined mounting plate further work on the actual slide can be eliminated.

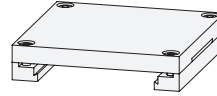

3.1

The plate is fixed with the fastening unit GN 900.1 on the adjustable slide unit.

3.2

The rotary plate GN 900.5 allows oblique positioning of the adjustable slide unit at any angle.

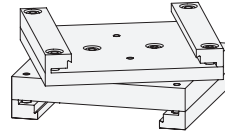

3.3

Adjustable slide unit with mounting plate GN 900.4 fitted to the base plate by using fastening unit GN 900.1.

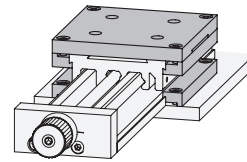

3.4

3.5

Adjustable slide unit X-Y, adjustable slide unit is fitted to the base plate using connecting set GN 900.2.

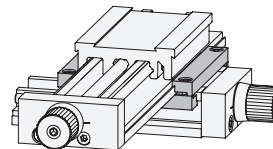

3.6

3.7

Adjustable slide unit X-Z, adjustable slide unit is connected together using the connecting set GN 900.3.

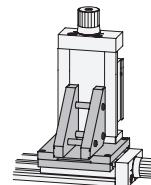

3.8

Adjustable slide unit X-Y, Y-slide with rotary plate GN 900.5 set shown in an angular position.

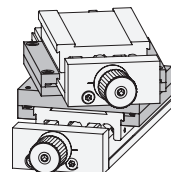

3.9

